

**Monuments, Memorials, Markers  
Private Mausoleums and  
Underground Vaults**

**Rules and Regulations  
For  
Catholic Cemeteries**

**Owned and Operated  
by**

**THE DIOCESE OF  
ROCKVILLE CENTRE**

Revised – February 11, 2011  
Nassau and Suffolk Counties, New York

**TABLE OF CONTENTS**

**GENERAL INFORMATION**

Ownership  
Official Adoption & Promulgation  
Mission Statement

**RULES AND REGULATIONS**

Preamble  
Need for Rules and Regulations  
A Statement of the New York State Diocesan Cemetery Directors  
Why it takes months to get a monument?  
Understanding Foundation beams and caps  
A level playing field (for monument sales)  
Definitions  
Statements concerning Vandalism  
Purpose of Monument Rules and Regulations  
Understanding Affidavits and Acknowledgements  
Evidence of Insurance  
General Monument Rules  
Application Submission and Approval Process  
Specific Regulations for Cemeteries  
    Lawn Crypts  
    Lotsite Monuments  
    Shrine Section Markers  
    Children's Plot Markers  
    Crypt and Niche Features  
Inscription Regulations  
Setting and Inscribing Monuments  
Monument Cleaning Services  
Family Mausoleum and Underground Vaults  
    Endowment Care  
    General Rules  
Modifications and Amendments  
Appendix  
    List of Approved Epitaphs  
    Cemetery Key Maps  
    Traditional Catholic Prayers  
    Affidavit Forms for Use {*office copy only – not at website*}

## **GENERAL INFORMATION**

### **OWNERSHIP**

The Rockville Centre Diocese owns and operates three diocesan cemeteries. The individual facilities listed below shall be referred to in these *Rules and Regulations* as “a cemetery” and collectively as “cemeteries”.

Cemetery of the Holy Rood  
111 Old Country Road  
PO Box 182  
Westbury NY 11590  
(516) 334-3970  
[www.holyroodcemetery.org](http://www.holyroodcemetery.org)

Holy Sepulchre Cemetery  
3442 Route 112  
Coram NY 11727  
(631) 732-3460  
[www.holysepulchrecemetery.org](http://www.holysepulchrecemetery.org)

Queen of All Saints Cemetery  
115 Wheeler Road  
Central Islip NY 11722  
(631) 234-8297  
[www.queenofallsaintscemetery.org](http://www.queenofallsaintscemetery.org)

*Future site of:*  
Queen of Peace Cemetery  
Old Westbury NY 11568  
[www.queenofpeacecemetery.org](http://www.queenofpeacecemetery.org)

***HINT:***

If you are viewing this on a computer monitor or if printed on a color printer you'll notice sections in **COLOR**. These colors associate a rule with a given cemetery.

### **MONUMENT & INSCRIPTION RULES AND REGULATIONS**

**OFFICIAL ADOPTION  
&  
PROMULGATION**

The *Monument Rules and Regulations* that follow are hereby adopted as the *Monument Rules and Regulations* for **Catholic Cemeteries** as herein named, and all owners of interment, entombment, inurnment rights, employees, visitors, contractors, and their employees performing work within the Cemeteries shall be subject to these *Monument Rules and Regulations* as well as such amendments and alterations as may be adopted by Catholic Cemeteries from time to time, with the same force and effect as such *Monument Rules and Regulations* and amendments as set forth in the Certificate of Burial Rights (Certificate), Purchase Agreement, or any other form or documents issued by Catholic Cemeteries or the Diocese of Rockville Centre.

**August 30, 2003**

Revised by Management Approval

On **Febryar 11, 2011**

---

*Peter J Ryan*

---

Peter J Ryan, CCCE  
Acting Director of Cemeteries  
Diocese of Rockville Centre

## Catholic Cemeteries : Diocese of Rockville Centre

### **MISSION STATEMENT FOR CATHOLIC CEMETERIES**

At the death of a Christian ... the Church intercedes on behalf of the deceased because of its confident belief that death is not the end nor does it break the bonds forged in life. The Church also ministers to the sorrowing and consoles them in the funeral rites. (OCF 4)

**WE ACKNOWLEDGE that the Catholic Cemetery, in the rich tradition of our faith, is a sacred place and the resting place of those who have died.**

Since in baptism the body was marked with the seal of the Trinity and became the temple of the Holy Spirit, Christians respect and honor the bodies of the dead and the places where they rest. (OCF 19)

**WE ARE DEDICATED to the reverential care of the bodies of those who have died, who, even in death, remain part of the Catholic Church.**

**WE Believe in and are firmly committed to the teachings and the tradition of the Catholic Church with regard to the deceased and the sacredness of the cemeteries in which their bodies rest.**

The community of faith proclaims that the grave or place of interment, once a sign of futility and despair, has been transformed by means of Christ's own death and resurrection into a sign of hope and promise. (OCF 209)

**WE ARE COMMITTED to the care of the graves and crypts of those who have been entrusted to us.**

**WE WILL PROMOTE prayer in memory of the departed and for the healing of the living through the celebration of the Eucharist and other opportunities for prayer in the Catholic Tradition in the cemetery.**

**WE WILL CONSOLE the bereaved through words and works.**

**WE CONFIRM our responsibility for stewardship of the resources of the Diocese of Rockville Centre, and our fulfillment of the Church's mission under the direction of the Bishop of Rockville Centre.**

**WE ACKNOWLEDGE our role as custodians of historical records, and will use methods and technology to assure their preservation.**

Lord, for your faithful people, life is changed not ended. (Preface, Funeral Mass)

**WE WILL REACH OUT to the community to promote Catholic teachings relating to suffering, death, burial and remembrance of those who have died.**

**WE WILL PROCLAIM through our words, work and example, the sacredness of all life, respect for the body, and belief in the hope of resurrection.**

## MONUMENT & INSCRIPTION RULES AND REGULATIONS

## MONUMENT RULES AND REGULATIONS

### PREAMBLE

For the mutual protection of Certificate holders and the Cemeteries and all who visit our cemeteries, the following *Monument Rules and Regulations* have been adopted by Catholic Cemeteries of Rockville Centre Diocese in the State of New York, as the monument, memorial, markers, private mausoleum and underground vault rules and regulations of Catholic Cemeteries, which are owned and operated by the Roman Catholic Diocese of Rockville Centre.

All Certificate holders, visitors, funeral directors, monument dealers, monument setters, monument inscribers and any persons or contractors, companies, etc. performing related or other work within these cemeteries, and all lots, plots, crypts and niches sold, shall be subject to these *Monument Rules and Regulations*, and subject further to such other rules, regulations, amendments or alterations as shall be adopted by Catholic Cemeteries of Rockville Centre Diocese from time to time. References to these *Monument Rules and Regulations* in the Certificate of the Right of Burial (Certificate) shall have the same force and effect as if set forth in full therein.

#### **General Statements Concerning Responsibilities towards *Monument Rules and Regulations* at our Cemeteries**

All of us in Catholic cemetery ministry are deeply saddened when a bereaved family experiences pain and disappointment rather than comfort and consolation at a cemetery. We can well appreciate each visitor's feelings and comments regarding the problems with monument regulations, the application and approval process, and the overall enforcement of these *Monument Rules and Regulations*.

Many families desire a highly personalized memorial for a loved one's burial place as an expression of their love and caring. The cemetery has to balance these desires with more practical concerns of appearance and upkeep. **One of our greatest concerns is for the sacredness and religious character of these cemetery grounds.** While not everyone will agree with all the rules, we ask that everyone accept them as contributing to our common goal – our Catholic identity in a well-kept and safe cemetery.

## MONUMENT & INSCRIPTION RULES AND REGULATIONS

## Catholic Cemeteries : Diocese of Rockville Centre



**Cemeteries should be forever!** *Monument Rules and Regulations* are a necessity for the long-term care and preservation of our Catholic history, society, and culture. **The monuments placed today will speak of this generation and provide a picture to our future world. We will be judged and teach a generation who we may never meet. What will we say? What will they learn from us?** The rules and the monument procedures provide a process for good record keeping, identification of monuments, the overall appearance and efficiency in maintenance of cemetery operations. Without these rules and procedures the long term care and appearance of the Cemetery would greatly suffer. Some basic information on the *Monument Rules and Regulations* are discussed and appear in the signed rules and regulations at the time of cemetery arrangements for each Certificate of Right of Burial (cemetery certificate) or lot/crypt/niche contract. A complete detailed set of the *Monument Rules and Regulations* have been distributed to each of our area monument companies. Additional copies are available upon request to the cemetery office. Each of these acts serves to alert all concerned of these *Monument Rules and Regulations*.

Unfortunately regulations are not always to everyone's taste, but most cemeteries have similar regulations which are the result of many years experience in trying to assist families in their grief, in creating a lasting memorial to remember a Catholic member of our faith, a life once lived and a testimony to our faith and belief in the resurrection. A well-regulated memorial program can achieve a beautiful, safe and good order cemetery that is efficient and allows the cemetery staff to perform their work efficiently today and tomorrow.

The cemetery reserves the right to remove a monument, marker or other memorial that has deteriorated, as well as a monument, marker or memorial placed that does not meet the guidelines in order to maintain the beauty, dignity, and safety of the cemetery grounds including lot sites, shrines, chapel and mausoleum areas.

### MONUMENT & INSCRIPTION RULES AND REGULATIONS

## Catholic Cemeteries : Diocese of Rockville Centre

Enforcement of these regulations does not mean that the cemetery guarantees any memorials. The deficiencies in quality remain the responsibility of the independent contractor and their granite supplier that the family has chosen. The cemetery will not be responsible for monuments fabricated or inscribed that have not been properly processed and approved. Damage and/or errors resulting from improper approval process will not be covered for reimbursement. Rectification of any damage or error shall be the lots original owner or the heirs, monument dealers, monument inscribers of the lots original owner.

Management reserves the right to change, modify, or rescind the Monument Rules and Regulations as it seems fit and deems necessary.

The general beauty and maintenance of the cemetery grounds (lot sites and the mausoleum areas) naturally suffers to the extent that time and labor is consumed in correcting errors and confronting violators of these rules. If infractions are permitted or overlooked, it would tend to result in increased infractions.

The Cemetery staff does inspect each memorial before and after setting, each inscription after the work is completed at the lot site.

The cemetery management may instruct our staff members or require the monument dealer's staff to remove a set memorial for the purpose of safety or correction.

### **Why the cemetery has rules?**

Our goal is to:

- Foster cooperation between the cemetery and those who visit here.
- Insure the continuation of the general plan set forth for the cemetery grounds.
- Design rules that protect visitors and workers from harm.

The cemetery's management is committed that all our cemetery's memorials are well maintained and image the Church's respect for the dignity of each individual human person.

*Monument Rules and Regulations* play a most important part in the beautification and preservation of the sacred resting-place of the faithful departed. They are intended not as restraining, but rather as defining an orderly plan of operation, care and permanent maintenance.

The placement of cemetery memorials, whether monuments, markers, memorial vases or of some other approved type, is strictly regulated for the common good of all lot sites.

**The cemetery makes every effort to enforce Monument Rules and Regulations uniformly and with compassion.**

## MONUMENT & INSCRIPTION RULES AND REGULATIONS



## Catholic Cemeteries : Diocese of Rockville Centre

We acknowledge and regret instances that appear contrary to these efforts.

In compiling the regulations and in considering revisions, we try to strike a balance between the natural desire of family members to personalize their individual memorials and the overriding obligation to maintain the appearance of the cemetery with a unique Catholic identity for many years to come.

It is always difficult to make Monument Rules and Regulations that a wide and diverse group of persons will agree on. Our Cemetery's rules are the standard regulations of the vast majority of cemeteries. **The goal of cemetery's monument, memorial, and marker regulations is to make the cemetery grounds religious, uniform, lasting, clean with an atmosphere of simplicity and elegance.** These regulations also ensure that the cemetery grounds are a safe place for both visitors and workers. While we certainly appreciate and commend one's love of secular devotional of great personal symbolism we sincerely trust all will understand the necessity of complying with the regulations.

Catholic cemeteries image the care of the Church for her people, which does not cease when death occurs. Those who have gone before us into the Communion of Saints lie in the consecrated space of the Catholic Cemetery; they are family, friends, fellow parishioners, and co-laborers, all believers in Jesus Christ, Eternal Life and the Kingdom of God. Whether summer or winter, whether in rain, snow or sunshine, those who work the grounds must keep these facilities in a condition that makes them both accessible and welcoming. Catholic cemeteries are to be places of remembrance and hope, prayer and comfort; they must be facilities that reflect the Church's theology about dignity of each human person, whether that person is alive or in the tomb awaiting the day of final judgment.

Comments and suggestions are always welcomed. If you have any questions or concerns regarding this or other matters, feel free to contact the cemetery office.

## MONUMENT & INSCRIPTION RULES AND REGULATIONS

## Catholic Cemeteries : Diocese of Rockville Centre

### **NEED FOR RULES & REGULATIONS**

There are three distinct groups that must be considered in the exercise of the Corporal Work of Mercy known as the Burial of the Dead. **Those who are buried, entombed, or inurned in our cemeteries are the first group.** The *Monument Rules and Regulations* are written for their protection. These individuals are entitled, even after they have died, to respectful burial, to the care and maintenance of their interment spaces, to a holy and beautiful environment of the Catholic cemetery, in recognition of our belief that cemeteries are “resting places” as we await as a community of faith for the final resurrection.

**The second group consists of the survivors and visitors to Catholic Cemeteries.**

Among this group would be those who have purchased spaces for future use, those who have loved ones or friends buried in one or more of our cemeteries, those who utilize our cemeteries as places for prayer and meditation, or those who come to our cemeteries to render services either to families or cemetery management and operations.

**The third group that must be considered includes the Catholic Church itself, its rituals, disciplines and procedures, cemetery management and all cemetery support staff** who are charged not only with the application of the Church’s directives, but who also must interact with families requiring our services, or visitors and others who come to the cemeteries to render services either on behalf of families or cemetery management.

These Monument Rules and Regulations are designed to chart a course of mutual cooperation and protection for all of these groups and the individuals within them. They are intended to help sanctify the living memories of those buried within the cemeteries and to create an environment within the cemeteries that awakens faith and brings consolation. The enforcement of the rules will assist in protecting the cemeteries, creating and preserving their beauty, and ensuring that the interests of all concerned parties are equally addressed.

### **A STATEMENT OF THE NEW YORK STATE DIOCESAN CEMETERY DIRECTORS**

Over the centuries, a tradition has grown that it is the right, privilege and duty of every Catholic to seek burial in a Catholic cemetery. However, living in the midst of changing circumstances has resulted in changing perceptions in the minds of some regarding the relevance of the Catholic cemetery in the scheme of their lives. While the Church has moved away from a legislative stance and no longer mandates that all Catholics be buried in Catholic cemeteries, the reasons for maintaining and using Catholic cemeteries are as powerful and compelling as ever. The usual and proper place for the burial of Catholics is still the Catholic cemetery in view of the values contained in the Church's burial tradition.

### **MONUMENT & INSCRIPTION RULES AND REGULATIONS**

## **Catholic Cemeteries : Diocese of Rockville Centre**

In the Creed, Catholics express as part of their faith belief in the Holy Spirit...the communion of saints...the resurrection of the body and life everlasting. These three doctrines are clearly demonstrated and symbolized in the Catholic cemetery. The Catholic cemetery is an expression of faith, an extension of the parish community, and a life affirming response to the universal mystery of death and resurrection.

The life of God dwells in the human person through the waters of Baptism. Catholic teaching has always presented the human body as the temple of the Holy Spirit. Consequently, the Church has concerned herself with regard for the body before and after death. We speak of treating the total human person with dignity in all the stages of existence. It is in this spirit that the Church provides cemeteries, which reflect the dignity of and reverence, for the body.

Today, it is asked with greater frequency whether the Catholic character of the cemetery is significant as long as the cemetery has dignity and beauty. Certainly there are many such non-sectarian cemeteries available.

The response is that public or non-sectarian cemeteries must be just that: non-sectarian. These cemeteries must be careful not to impinge on the religious beliefs and personal sensibilities of those who will use their facilities and these are people of varying beliefs and no beliefs. By their very nature, non-sectarian cemeteries are devoted principally to the memorialization of the deceased.

Catholic cemeteries, on the other hand, serve as a symbol or extension of the parish community. They give witness that the community of faith is unbroken by death.

Moreover, we are one with Christ in life, death, and resurrection. St. Paul tells us, "If we have grown into union with him through a death like his, we shall also be united with him in the resurrection" (Romans 6.5) and "...whether we live or die, we are the Lord's" (Romans 14.8).

This union with Christ and community was evident in the early crypts, which served not only as burial places but also as places for the celebration of the Eucharist. The memorial of the death and resurrection of the Lord offered the promise of eternal life. Later, a tradition of local Catholic cemeteries arose as the sacred places where the remains of the beloved dead might be interred with reverence and respect. Often the cemetery was located behind or adjacent to the church so that the faithful could be buried near the altar, near the place where the Pascal mystery was memorialized. The continuity of the faith community is symbolized in a beautiful way by such parish cemeteries. Catholics wanted to be buried near the place where they had worshipped in life, near the community of which they had been a part.

## **MONUMENT & INSCRIPTION RULES AND REGULATIONS**

## Catholic Cemeteries : Diocese of Rockville Centre

The pattern of Catholic population growth now often requires larger regional cemeteries as well as those attached to parishes. The principle remains that Catholic cemeteries are an integral part of the Church's traditions and rites. In the Code of Canon Law, Catholic cemeteries-like churches, chapels, shrines and altars-are considered "sacred places." They are given a special blessing to set them apart and to highlight their sacred character. Likewise, the Order of Christian Funerals refers to three principal moments: the vigil (wake), the Funeral Mass (parish church), and the committal (cemetery). This corresponds to the Catholic tradition which includes sacred times (vigil), sacred rites (funeral), and sacred places (cemeteries).

Another way in which Catholic cemeteries differ from non-sectarian cemeteries has to do with Catholic belief about human destiny. Catholic cemeteries are not just memorials to the dead or monuments to times past. They do not honor the deceased merely for what they did on earth. Nor is respect and reverence emphasized solely because the body had been sanctified by the sacramental life. Catholic belief about death as symbolized by the white vestments and the Paschal Candle used at the Funeral Mass, focuses on hope in the promise of the resurrection. Not only does the soul live on but the total human person is destined for final glorification, final transformation into the image of Christ.

Catholic cemeteries are monuments to eternity. They speak the special message of Christian belief in the abundance of eternal life to a world that at times seeks fullness of life within the passing realities of space and time. Catholic cemeteries proclaim the sublime mysteries of faith in a personal God, of hope in the resurrection of the glorious reunion of the members of Christ's Mystical Body. As such, Catholic cemeteries are a consolation to the bereaved and an inspiration to the living.

Catholic churches bear testimony to belief in the existence of God and his revelation to us through Jesus Christ. Catholic educational institutions testify to the community's faithfulness in spreading the good news and to concern for the education of the entire human person. Catholic hospitals manifest the lasting interest of the Church in the total well being of its members. Other Catholic institutions for the young, the troubled, the aged and the less fortunate declare to the world that the love of Christ is alive in the modern world. So too, the Catholic cemetery is an eloquent witness. It professed belief in the resurrection of the body and eternal life. The Catholic cemetery is a holy place where religious ceremonies are held, where people pray for their beloved deceased, where the living find the consolation of faith.

Death is an experience that touches all. A visit to a Catholic cemetery is a reminder of what death is all about- a step to a new and eternal life with the Risen Lord. Christ has died! Christ is risen! Christ will come again!

*Romans 8:29*

*1 Corinthians 11:7 : 15:49*

*2 Corinthians 3:18*

*Col 3:10*

## MONUMENT & INSCRIPTION RULES AND REGULATIONS

## Catholic Cemeteries : Diocese of Rockville Centre

**Maintaining a fair and competitive sales environment or “a level playing field.”**

**The Catholic Church itself, its rituals, disciplines and procedures, cemetery management and all cemetery support staff** who are charged not only with the application of the Church’s directives, but who also must interact with families requiring our services, or visitors and others who come to the cemeteries to render services either on behalf of families or **cemetery management. As church, as Catholic cemeterians, we must review and renew our responsibilities, commitments and the general concerns of the family’s selected delegate (their: monument dealer, monument setters, and monument inscribers).**

Any and all efforts should be made to **renew a spirit of cooperation and assistance to each of these private contractors who serve the very same people our Monument Rules and Regulations are designed to help and protect.** Our service to the monument dealer is a service to the family. Monument dealers likewise are encouraged to learn more about the purpose and intent of Catholic Cemeteries, understand the rules set forth herein, the mission and ministry of the Church and gain a competitive advantage as well as provide genuine service to families in their time of need.

**Why it may take months to get a monument?**

Like so many other business and service industries, the monument selection, drafting, review, modifications, approval, fabrication, delivery, installation, inspection and acceptance process can be lengthy. It’s not uncommon to wait for a monument to be set from a period of eight (8) weeks extending up to and even beyond a period of six (6) months sometimes even one year after the order.

Several factors to consider:

- Choice of monument? Type, Color, size, style, symbols, epitaphs, terms of endearment, appearance of names all in accordance with regulations.
- Approvals? Cemetery Certificate (or duly executed affidavit), Cemetery fees (foundation and inscription), Monument dealer’s terms and conditions.
- Season? Weather? Concrete work may or may not be completed year round. Monument dealers are prohibited from setting in inclement weather and when the temperature falls too low. Snow rain and icy conditions restrict work activities and permissions. Holidays? Many people want the same thing from the same people at the same time --- their monument set before a holiday visit. Often dealers are pressed to commit to several families for the same set date. Advance planning can make it easier for all concerned.
- Foundation cap work and foundation beam work can delay the installation of a monument for several weeks or months depending of the circumstances.

## MONUMENT & INSCRIPTION RULES AND REGULATIONS

## Catholic Cemeteries : Diocese of Rockville Centre

### **Understanding Foundation costs. What are foundation beams and foundation caps?**

The cemetery collects a fee for the foundation placed at the lot. Due to weather conditions, winter seasons, and the overall conditions surrounding burials such as lot openings, soil settlement, grass growing and other cemetery related work, often foundations are “pre-poured” in the area before the grave or lot is even placed for sale. By completing this work in advance the cemetery is able to provide a stronger, more consistent foundation throughout the area. The actual area seen at the surface of the lot is called a “foundation cap.” The foundation cap extends from the surface to a horizontal beam beneath the earth generally below the designated area frost line. The cap is generally a smooth finish area controlled by assembled forms placed at the time of installation. *An analogy may be that a foundation cap and a foundation beam appear as an inverted comb or a row of teeth extending from the gum area.* The spaces between the caps provide area for soil and grass growth.

The labor in excavation, framing, pouring, and materials such as rebar reinforcement placement, concrete, area restoration are all additional work related expenses incurred in the preparation of the monument’s foundation and its actual cost.

### **DEFINITIONS**

The following definitions cover terms used in the *Monument Rules and Regulations* as well as terms used by personnel of the Cemeteries. As used in these *Rules and Regulations*, the following terms shall have the meaning hereinafter defined, unless a contrary intention appears from the context of any particular regulation.

**Affidavit** is a signed statement, duly sworn to by the maker thereof, before a notary public or other officer authorized to administer oaths.

**Affiant** means the person who signs the duly sworn statement.

**Burial** means the disposition of full (as opposed to cremated) human remains under the ground.

**Care** means that the general maintenance of the cemetery and of the lots, graves, crypts, niches, family mausoleum, memorials, and markers therein is the sole discretion of Catholic Cemeteries, including cutting and trimming of lawn and trees at reasonable intervals, keeping in repair the drains, water lines, roads, buildings, fences and other structures, in keeping with a well-maintained cemetery. It also includes overhead expense necessary for such purposes, including maintenance of machinery, tools and equipment for such care; compensation of employees, payment of insurance premiums, reasonable payments for employee benefit plans, and maintaining necessary records of ownership, transfers and burials.

## MONUMENT & INSCRIPTION RULES AND REGULATIONS

## Catholic Cemeteries : Diocese of Rockville Centre

**Catholic Cemeteries** shall mean the facilities identified as:

- A. Cemetery of the Holy Rood, Westbury;
- B. Holy Sepulchre, Coram;
- C. Queen of All Saints, Central Islip;
- D. Queen of Peace (a future cemetery site in Old Westbury);

**Cemetery** shall mean the locations listed above and as is used herein shall mean all the property for ground burials and mausoleums for crypt and niche entombments and inurnments, roads, paths, maintenance garages, administration facilities, entrances, fences, and the lands constituting the cemetery.

**Cemetery Office** shall mean the main office of the cemetery administration on the cemetery grounds.

**Cemetery Services** means opening and closing lots, crypts or niches; setting grave liners and vaults; setting markers; and long-term maintenance of cemetery grounds and facilities.

**Certificate of the Right of Burial (Certificate)** is the original certificate issued to an individual which grants the privilege or right of burial, entombment, or inurnment in a specific lot, plot or crypt. It does not convey ownership of land or other interest in the lot, crypt, niche or plot to which it refers.

**Certificate holder** is the person (original owner, heir or other authorized person) who is actually in possession of a valid Certificate of interment/entombment/inurnment rights.

**Duplicate Certificate of Right of Burial (Duplicate Certificate)** is the duplicate certificate issued to an individual which confirms the privilege or right of burial, entombment, or inurnment in a specific lot, plot, crypt or niche. It does not convey ownership of land or other interest in the lot, crypt, niche or plot to which it refers.

**Columbarium** is a structure with niches (small spaces) for placing cremated human remains in urns or other approved containers. It may be outdoors or part of a mausoleum generally in a community setting such as a garden and chapel mausoleum.

**Contractor** means any person, firm or corporation or anyone engaged in placing, erecting, inscribing or repairing any memorial, or performing any work on cemetery grounds other than an employee of the cemetery.

**Cremation** (using fire and heat) is the process by which the body of the deceased is reduced to its basic elements. Cremation is permitted for Catholics as long as it is not chosen in denial of Christian teaching on the Resurrection and sacredness of the human body.

## MONUMENT & INSCRIPTION RULES AND REGULATIONS

## Catholic Cemeteries : Diocese of Rockville Centre

**Cremated Remains** means human remains after incineration in a crematory.

**Cremation Niche** the final resting place for cremated human remains in a cemetery.

**Crypt** - A space in a mausoleum or other building to hold whole human remains. **Abby Companion Crypt** – A crypt located at the first level, commonly referred to as an A-level crypt in a mausoleum building whereas the companion crypt retaining the first entombment at ground level. Some Abby Companion Crypts are also designed for four entombments whereas the first two are located at ground level and the second two caskets are located above. **Companion Side-by-Side Crypt** – The placing of two caskets into individual crypts next to each other (side to side) whereas one crypt cover (memorial shutter) is placed covering both crypt fronts. **Single Crypt** – a crypt designed for one casket space. **True Companion Crypt** - The placing of two caskets into a single crypt head to head with one crypt cover (memorial shutter) is placed covering the single crypt front. **Couch Crypt** - The horizontal placing of two caskets into a single crypt next to each other (side to side) with one crypt cover (memorial shutter) placed covering the crypt opening.

**Entombment** means the placement of full (not cremated) human remains in an above ground mausoleum crypt.

**Family (Private) Mausoleum** means a structure above ground, or partially above and partially below ground, containing crypts, the use of which is restricted to a group of persons related to each other by blood, marriage, or adoption.

**Foundation** means the in-ground base, usually a concrete beam, upon which a memorial is installed.

**Grave-** a space in the ground in a cemetery for the burial of human remains beneath the earth. **Upright Memorial Grave** – A lot that permits a memorial to extend above the grade. **Flush Marker Grave** – A lot that permits a memorial to remain flat or flush to the grade.

**Interment** means burial below ground, beneath the earth.

**Inurnment** means the placing of cremated human remains in an urn and a placement of such urn in a niche or lot or other suitable location in a cemetery.

**Maintenance** means the physical upkeep of a cemetery's grounds and buildings as defined under Care.

**Management (Cemetery Authorities)** - means the Catholic Cemeteries of the Rockville Centre Diocese, a religious corporation, and the person or persons duly appointed by the Diocesan Bishop of the Rockville Centre Diocese for the purpose of conducting and administering Catholic Cemeteries.

## MONUMENT & INSCRIPTION RULES AND REGULATIONS



## Catholic Cemeteries : Diocese of Rockville Centre

**Marker (Flush and/or Bronze)** means a memorial made principally of stone (pink granite) with a bronze plaque attached to the top of it. The marker lays flat to the surface of the earth, in flush form. Markers are currently restricted to designated lots in designated sections of the cemeteries. The size, content and other characteristics are subject to regulations. (*See the General Rules and Regulations for lots published under separate cover.*)

**Mausoleum Crypt** means space in a building capable of holding a casket. (Mausolea is generally accepted as the plural form of mausoleum).

**Memorial** shall include monument, mausoleum, underground vault, tombstone, headstone, grave marker or tablet or inscription on crypt front or fronts, for one or more deceased persons.

**Monument** means a memorial made principally of stone that extends above the surface of the earth, in upright form. Monuments are currently restricted to designated lots in designated sections of the cemeteries. The size, content and other characteristics are subject to regulations. (*See Monument Regulations published under separate cover.*)

**Niche** a space in a columbarium, mausoleum or niche wall to hold an urn.

**Original Owner** is the person whose name is recorded on the certificate as the purchaser of interment/entombment/inurnment rights. The original owner is usually designated and referred to as the Certificate holder during his or her lifetime.

**Permanent Maintenance Fund** is all of the money that is allocated from the sale of each interment, entombment or inurnment and placed in trust for the maintenance and upkeep of the entire cemetery. The income generated from the investment of this fund is expensed in current operating costs (care costs). Care standards are set based upon the income available. Income in excess of care costs shall be retained for the continued maintenance, repair or renovation of the cemetery as a whole.

**Perpetual Care** - is an endowment care that consists of the income received to provide for the care in perpetuity and as such is subject to legal provisions that apply to trust funds requiring that the principal be invested in order to provide income for care of the endowed item. Care standards are set based upon the income available. Income in excess of care costs shall be retained, reinvested for the continued maintenance, repair or renovation of the endowed item. One example of an endowed item is for the care of a family (private) mausoleum.

**Plot or Family Plot** shall include and apply to a lot space of more than one adjoining lot recorded on one certificate.

**Purchaser** is the person who has signed the Purchase Agreement (Contract) for the purchase of interment/entombment/inurnment rights.

## MONUMENT & INSCRIPTION RULES AND REGULATIONS

## Catholic Cemeteries : Diocese of Rockville Centre

**Temporary Marker** is a marker placed on a lotsite after burial and is generally removed at the time a monument is placed.

**Underground Vault** – is a lawn crypt vault-style lot site where the cover also serves as the memorial and it extends to ground level or above ground level.

### **Statements on Cemetery Vandalism**

**Vandalism** – defined as the willful damage, malicious destruction, injury, disfigurement or defacing of property belonging to the cemetery or another person such as a visitor or lot owner is a criminal offense. Vandalism may be perpetrated wherever the opportunity exists - often in cemeteries after hours and after dark, at times when the premises are not occupied. Usually vandals do their mischief when they think that no one will see them - at least no one who is likely to stop them.

*The malicious damage of private property, such as a bored group of young people breaking windows or destroying the interior of a chapel or family mausoleum building is an act of vandalism. A cemetery site under construction or damage to the undeveloped area of cemetery land are other examples of vandalism. Everyday negligence including gum under seats, graffiti, and carpet burns in public places are additional examples of vandalism. Most publicly noted are the incidents of unreasonable Halloween pranks and cases including arson on cemetery grounds.*

### **Catholic Cemeteries' Preventative Measures for everyone.**

**These measures include the following four areas:**

**education, social programs, criminal justice system, and opportunity education.**

- Improved lighting and security presence.
- Restrict visitation of minor children with responsible adult supervision.
- Securing the property promptly with set daily closing times and locking all gates and points of entry.
- Securing all cemetery buildings, vehicles, and hand tools and equipment to avoid mischief use or abuse.
- Routine inspection of security lighting, fencing, and gate security.
- Restricting the height and size of memorials and items placed at the burial site.
- Controls with required monument setting permits, inspection of set memorials, and mandating corrections for violations and hazards.
- Alert Visitors to rapid reporting of incidents of vandalism, as well as suspicious persons loitering in an area where an act of vandalism may be committed. Do not assume that someone else has already made the call. Contact the cemetery office immediately to report an incident.
- Maintain a "good neighbor" policy, watch out for your neighbors' lot, monument or crypt as well as your own.
- Encourage parents to be aware of their children's associates and social activities.
- Keep local law enforcement agencies informed about acts of vandalism to cemetery property.

## MONUMENT & INSCRIPTION RULES AND REGULATIONS

## **Catholic Cemeteries : Diocese of Rockville Centre**

- Each of us should inform our own children of the criminal consequences of vandalism.
- Encourage adults to teach children of the sacred nature of a catholic cemetery and general respect for the dead. Observe Cemetery Sunday and participate in services.

*Vandalism comes in many forms and robs people of time, money and personal property. Vandalism in a cemetery can be an act of discretion to a sacred resting place. Vandalism is the willful destruction of chapel, office, and service buildings, such building that belong to the church and its people here in the diocese of Rockville Centre.*

### **When Does Vandalism Happen?**

Vandalism can happen any time of the day or night and in any season, but it most often occurs in the evening during summer. The most common act of cemetery vandalism is to pushing over a cemetery monument. A vandal can complete this act swiftly and see instant results to their hideous actions. Halloween time and general pranks make cemeteries a target for vandalism.

Vandalism has a tendency to decline during winter months when individuals spend less time outside. There is generally a decline on Saturdays and Sundays during visiting time since there is a greater number of visitors present in the cemetery, in the cemetery's buildings and the vast open space areas remain under greater scrutiny with both security personnel present and other visitors in most of these areas.

### **Who Commits Vandalism?**

There is no single type of vandal. Both sexes and generations are guilty. Male adults commit most vandalism to cemetery property. Female adults are the second most frequent offenders. Juvenile males commit most vandalism to family monuments and cemetery statuary. Female juveniles are second.

### **Where Does Vandalism Happen?**

It happens everywhere, but most often where building design and lighting offers concealment and anonymity, in areas frequented by young people attracted to a cemetery's quietness, seclusion, and park like setting, family mausoleum buildings, and in unoccupied community mausoleum buildings, open spaces of undeveloped cemetery land and parked cemetery vehicles where minimum surveillance is given to these specific properties.

## **MONUMENT & INSCRIPTION RULES AND REGULATIONS**

## Catholic Cemeteries : Diocese of Rockville Centre

### Can We Combat Vandals?

- Yes. Be alert to what is going on in the neighborhood and on cemetery grounds. Be a responsible citizen and report acts of vandalism to cemetery authorities and to the local police agency. Set a good example for your family and friends. If you see someone about to damage property or pilfer flowers and decorations, discourage them.
- It has been proven to be an effective means of reducing vandalism by enlisting the active support of community residents in protecting our neighborhood and all our properties. Know what your children are doing teach children to value all property including their own.

### Insurance as it pertains to a vandalism claims?

The cemetery insures the property and equipment owned by the cemetery. The cemetery accepts responsibility for damage to another person's property when the damage is determined by cemetery authorities to be damage sustained by cemetery personnel and cemetery equipment.

Individual property such as flowers, decorations and bouquet holders and monuments are all regulated but remain the property of the family. Such items are generally insured or claimed by a homeowner or other personal insurance policy. The cemetery does not insure or guarantee these items from damage, theft or disappearance. The cemetery will not accept or initiate a claim for these items.

As a practice, Catholic Cemeteries does not contribute to the New York State vandalism fund as required by regulated cemeteries and no fee is collected for the fund nor do we submit requests or claims against this fund.

*Some important suggestions for vandalism reports:*

- *Provide a name, address, and telephone number of one contact (spoke person) for police, cemetery, and/ or insurance representatives to relay the information.*
- *Review the content of your monument contract/ purchase receipt for guarantee and warranty conditions. Make a copy of the contract for your insurance provider.*

## MONUMENT & INSCRIPTION RULES AND REGULATIONS

**Catholic Cemeteries : Diocese of Rockville Centre**

**PURPOSE OF MONUMENT RULES & REGULATIONS**

The purpose of these *rules* is to achieve long lasting, safe, and dignified religiously appropriate cemetery monuments, to prevent abuses with regard to size, design, and theme, and to foster a spirit of mutual cooperation between the cemeteries and monument dealers.

All persons are reminded that Catholic Cemeteries have been consecrated or dedicated by the Church and designed for the interment of the dead. The observance of all that is proper and respectful is expected of everyone. All monument work shall cease in the immediate area during services.

The authorities of Catholic Cemeteries reserve the right at all times to approve and prescribe the kind, size, design, religious and non-religious appropriate symbolism, safety, craftsmanship, quality and material of monuments and markers placed or to be placed in these cemeteries. The following *Monument Rules and Regulations* have been adopted to carry out the foregoing aims and purposes.

**Cemetery Affidavits and Acknowledgements**

*Use Cemetery Application/Affidavit Statements and forms sparingly*

Most situations and requests to the cemetery's management related to cemetery monuments and inscription work do not require an affidavit. A simple review of procedures outlined in the *Monument Rules and Regulations* are in most cases sufficient to meet cemetery requirements. However under some circumstances, the cemetery may choose and/or require affidavits as the best means of accomplishing an objective.

Under circumstances where the *Monument Rules and Regulations* or the *General Rules and Regulations* do not provide a full procedure and a request for affidavits cannot be completed the cemetery may require "court order action" to accomplish an objective.

***Affidavits are intended to be an amendment to cemetery records clarifying the Original owner's intent.***

Affidavits in general are cemetery prepared forms where someone is making a statement to be recorded in cemetery records for a particular burial space. These generic forms are reviewed and deemed acceptable by legal counsel to assist with the protection of Catholic Cemeteries as an entity, its management, the Roman Catholic Diocese of Rockville Centre, the original owners within Catholic Cemeteries, their heirs, funeral directors, monument dealers, and other interested parties with a clear statement that is evidenced as sworn to in front of a Notary Public that will allow decisions to be made by cemetery management. These affidavits are presented to the cemetery's management for review and consideration of acceptance. When accepted the form is affixed to the original

**MONUMENT & INSCRIPTION RULES AND REGULATIONS**

## Catholic Cemeteries : Diocese of Rockville Centre

owner's record, in essence an amendment or modification to the cemetery record system has been made.

The affidavit form is prepared for free; however, a fee is collected for the "recording of the affidavit" in the cemetery records.

When a third party prepares an affidavit, it must be in an acceptable format to cemetery management. The cemetery at its own discretion can choose to accept or reject the document based on form, legibility, paper quality and its overall content.

Some examples of approved cemetery affidavit/document forms for monuments include:

- Application for Duplicate Certificate of Right of Burial (Duplicate Certificate).
- Monument inscription correction of an error
- Removal of a cemetery monument
- Special use - Color of a monument
- Inscription of a different surname, Inscription Pre-Need (Future Use)  
Inscription Placed "In Memory of", Inscription without a certificate
- Install a cemetery monument without the cemetery certificate

Many of these forms appear in the Appendix of this document (located at the cemetery office).

### **EVIDENCE OF INSURANCE**

Monument Dealers, Mausoleum Contractors, Monument Setters, Vault Companies and/or other Contractors must submit evidence of insurance in an approved form to the cemetery management for approval to work on cemetery grounds. Evidence of Insurance (Certificates) must be renewed each year/prior to expiration.

### **GENERAL**

**1. Community Mausoleum Inscriptions and Features are cemetery property and responsibility.** Families are to arrange for features, crypt and niche inscriptions through the cemetery office only. Sales literature and price information will be provided for families to review.

**2. The cemetery office sells and installs bronze bouquet holders and flush bronze markers** (where permitted). Contact the cemetery office for additional information on these items.

## MONUMENT & INSCRIPTION RULES AND REGULATIONS

## Catholic Cemeteries : Diocese of Rockville Centre

3. **The cemetery's management permits families to contract with monument dealers that are insured and authorized to work** on cemetery grounds. Families and or monument dealers (setters and inscribers) may contact the cemetery office for additional information on this requirement.
4. Soliciting monument sales or monument work within the cemetery, or through cemetery personnel is prohibited.
5. The use of the cemetery name in advertisements, telephone sales, brochures or other material, direct marketing, mailings, or in any way, for the purpose of promoting a dealer's business is prohibited.
6. No member of the cemetery staff shall be interested directly or indirectly in any business connected with the erection of mausoleums, monuments, vaults, etc, nor shall they recommend the employment of any particular firm.
7. The cemetery authorities reserve the right to amend the foregoing *Monument Rules and Regulations*, and to make such other Monument Rules and Regulations, from time to time as they deem necessary and proper.
8. All Certificate of Right of Burial (Certificate) held by memorial dealers should be returned to the plot holder as soon as the application has been approved. Should it be brought to the attention of the Cemetery officials that any Certificates are being held and not returned to the proper party, no further memorial will be permitted to be set until such Certificates are returned.
9. Monument dealers, Certificate holders, contractors, families and visitors must abide by all Monument Rules and Regulations pertaining to the erection of monuments and inscribing on existing memorials.
10. All memorials are subject to the approval of Cemetery Management prior to their fabrication and erection.
11. Size and the number of pieces of memorials will vary with the size of the lot or plot. Memorial size regulations should be obtained from the Cemetery Management at the time of purchase of the Right of Burial.
12. Every memorial shall be set on a foundation. All foundation work will be done under the supervision of the Cemetery Management. Fees for foundations and other work shall be collected at the time the application is submitted. For current fees, contact the cemetery office.
13. Replacements or additions to memorials must be of granite.

## MONUMENT & INSCRIPTION RULES AND REGULATIONS

## **Catholic Cemeteries : Diocese of Rockville Centre**

14. Only one memorial shall be permitted on a burial lot. For each Certificate, there may be only one memorial. Subject to approval, the memorial may be a monument from a monument dealer, a government marker, a hickey marker. An approved, memorial bouquet holder may also be placed in addition to the cemetery monument/marker.

15. A memorial may not be erected on more than one burial space. An exception to this rule is for a two-sided 10" thick single monument, front to back locations with the certificate recorded in the same person's name.

16. The cemetery regulates all symbols on monuments based on size of the monument. Some of the acceptable or permitted symbols are:

- Crosses (larger than the four symbols permitted below)
- Symbols representing a profession
- Emblems representing Military Service (must be accompanied by a copy of Honorable Discharge papers)
- Symbols representing a hobby
- Portraits or Etched busts

In addition to size, the cross and the religious symbols must appear on all memorials in a prominent position. Secular symbols of a profession and a hobby will only be approved if they remain secondary to the cross and other religious symbol in both size and position or layout on the memorial. All symbols must be approved by cemetery management.

17. The Cemetery reserves the right to remove any memorial that is in a dangerous condition or that is detrimental to the general appearance of the Cemetery. Upon inspection, the cemetery reserves the right to remove any memorial in violation of the *Monument Rules and Regulations*.

18. If, in the opinion of the Cemetery Authorities, the completed memorial does not comply with the Monument Rules and Regulations of the Cemetery, or agree with the approved sketches of the application, such memorial will be rejected upon inspection by cemetery authorities. If discrepancies are observed after the monument has been set, the dealer will be notified and the memorial must be corrected, if necessary removed and corrected as approved by cemetery authorities.

19. No enclosures of any kind whatsoever are permitted.

20. Footstones are not allowed.

21. Photographs and pictures of persons, living or deceased may not be affixed on memorials or lots. A maximum of two etchings of persons are permitted on a memorial. Each etching shall not exceed 4" x 4" in size. Affidavit is required at time of application.

22. No memorials or other stonework may be placed on plots having enclosures unless the enclosure is first removed.

### **MONUMENT & INSCRIPTION RULES AND REGULATIONS**



## Catholic Cemeteries : Diocese of Rockville Centre

23. Corner markers and corner posts are not permitted.
24. The Cemetery reserves the right to fix charges for memorial foundations, memorial placement or removal, inscription permits, and the right to demand that such charges be paid in advance before said work is completed.
25. The cemetery will not approve or permit memorial and inscription work until annual care charges are paid in full.
26. For a memorial inscription of a name not listed in the cemetery's burial records, in addition to the presentation of the certificate for inscription, the cemetery will require an affidavit executed by the Certificate holder or if deceased, their heirs at law.
27. A detailed plan and design of a memorial must be submitted to the Cemetery Management for approval before a permit will be issued, and no memorial shall be erected or placed until checked, approved and accepted by the Cemetery's Management.
28. Enforcement of these regulations does not mean that the cemetery guarantees any memorials. The deficiencies in quality remain the responsibility of the independent contractor and their granite supplier that the family has chosen.

### **APPLICATION SUBMISSION AND APPROVAL PROCESS**

1. Under separate cover, the cemetery's management has included the *Rules and Regulations* relative to plot and lot site Certificate holder-ship and rights therein, restrictions of Certificate holder-ship and rights therein. Monument dealers should be aware that in certain circumstances a cemetery prepared affidavit might be required prior to the commencement of any work or approval of such work from cemetery management. The monument dealer should contact the cemetery office to ensure the monument complies with our governing general *Monument Rules and Regulations*. The cemetery will not be responsible for the cost of a monument purchase or inscription work that has not been submitted and approved by cemetery management in writing.
2. The present system of application in triplicate is to remain in force for all stonework and inscription work for the cemeteries of the Diocese of Rockville Centre.
3. Please note that the first sentence on the application reads: "All applications must be accompanied by a clear sketch, design in detail, and all dimensions in scale, including any inscription or ornamentation exactly as they are to appear on the finished work". Any application that does not fully comply with the above quoted section of the application will be rejected for correction and a resubmission.
4. If through oversight or error, or for any other reason, a monument has been erected, that monument contains a violation to either past, existing or future *Monument Rules and Regulations*, such violation in no way are to be considered as a precedent.

### **MONUMENT & INSCRIPTION RULES AND REGULATIONS**

## Catholic Cemeteries : Diocese of Rockville Centre

5. Lot location numbers must appear on all memorials erected in the Cemetery. They shall appear in lettering of ¾", the Section, Range and Lot Number in that order on the right side of the monument half way up from the bottom of the monument. Polish is to be removed from a polished monument and lettering must be "V" sunk. Any monument that does not comply with this regulation will not be set until the rule is complied with.
6. The application must be accompanied by the following:
  - a) The original certificate, or the Duplicate Certificate of Right of Burial, in the absence of the certificate, a duly executed affidavit prepared by the cemetery;
  - b) A check for the foundation fee, or monument removal fee, inscription fees, and annual care charges, if any. Fees are subject to change without prior notification. Contact the cemetery office for current charges;
  - c) Contractors are required to telephone the cemetery office to ascertain the annual care charges, unless a Permanent Maintenance receipt is affixed to the cemetery certificate or is recorded on the face of the certificate;
  - d) Upon personal presentation, the certificate will be returned immediately.
7. All changes on monuments after submission of the application must be approved by the cemetery before the work is started. Amended applications covering such changes must be submitted at the cemetery office. **Amended applications must be accompanied by payment of an application fee.** *Do the application once, do it right, make it complete and final and save money!* Verbal notification of a change order or verbal approval of a change order is deemed insufficient and not binding as meeting the cemetery's requirements for change notification.
8. No memorial once erected may be removed by a monument dealer or setter from the lot site in the cemetery without written permission of the holder of the Certificate of Right of Burial (Certificate) or, if deceased, his or her heirs, together with a written approval of Cemetery Authorities or a Court Order.
9. The texts of all inscriptions are subject to approval of the cemetery Management. Foreign language inscriptions must be accompanied by an English translation of the inscription. All applications for inscription must include the size of the inscription.
10. Lettering sizes must be shown next to the sketch beside each line of lettering. These sizes must also be indicated on the application for inscription work.
11. If a monument is to be removed from the cemetery, a duly executed affidavit prepared by the cemetery must be filed with the cemetery in addition to a completed monument application prior to removal. If the monument is to be refaced, the application must also indicate the existing inscriptions.
12. All memorials are subject to the approval of Cemetery Management prior to their erection.

## MONUMENT & INSCRIPTION RULES AND REGULATIONS

## Catholic Cemeteries : Diocese of Rockville Centre

13. Size and the number of pieces of a memorial will vary with the size and location and type of the lot or plot. Memorial size regulations are available to Certificate holders at the time of purchase. All Upright Monuments must be a minimum of 8” in thickness. Please verify sizes of memorials before submitting applications.

14. Every memorial shall be set on a foundation. All foundation work will be done under the supervision of the Cemetery Management. Foundation fees and other fees shall be collected at the time of application.

15. Where permitted, Flush Markers shall be made of granite and be pink in coloration (comparable to Salisbury Pink). The marker must be exactly 28” in length, 18” in width, 3” to 4” in height. The marker must have a polished top and a sawed finish on all other sides. The bronze plaque, when considered separately, must be exactly 24” in length and 18” in width. The alloy composition is detailed in the *specific regulations* by cemetery below.

16. Monument’s Composition:

- a. Memorials must be of granite, which granite is to be first quality, certified quarry stock, free of cracks, seams, doctoring and knots, approved for use in memorialization;
- b. Memorials of any other material such as marble, slate, concrete, cast iron, etc. are prohibited;
- c. Monuments must have a polished or steeled (axed) finish only. No other finishes are permitted;
- d. No honed finishes;
- e. Free from ridges on tops, sides and edges;
- f. All bottoms to be finished rough over full area;
- g. Whenever a base and dies is used, such base must have an appropriate wash, and be joined to the die with 6” bronze dowels. [Specified area at Holy Sepulchre cemetery are exempt from this requirement;](#)
- h. At Holy Rood Cemetery, whenever a freestanding cross is permitted, cross itself must be one-piece and joined to base with mortice and tenon.

17. Ornamentation and Design:

A centered cross on a cemetery monument is perhaps one of the greatest expression of our Christian faith. It stands for the redemptive power of our Lord and Savior Jesus Christ. The symbol is more than a symbol of a temporal death. It is a reminder of Christ’s love, sacrifice, forgiveness, our salvation and redemption. It also represents our belief and hope in the resurrection and the promise of eternal life. For this reason a cross must appear on every cemetery monument. **The cross must be unadorned by floral decoration or other symbols** unless they are considered an integral part of the cross (e.g. shroud, rosaries, (IHS) and must be a minimum of 9” and a maximum of 11”.

Below are some examples of acceptable alternate designs for approval when a center cross is not chosen as the design:

## MONUMENT & INSCRIPTION RULES AND REGULATIONS

**Catholic Cemeteries : Diocese of Rockville Centre**

- a. A Cross is to appear on all monuments. **At Holy Rood Cemetery on four grave plots and larger, cross must be placed on front and rear.** On a 1’8” x 0’8” x 2’0” die (single lot) or on a 3’0” x 0’8” x 2’0” die (double lots) a prominent cross may be placed on the side of the monument instead of centered as usual. **The cross must be unadorned by floral decoration or other symbols** unless they are considered an integral part of the cross (e.g. shroud, rosaries, (IHS) and must be a minimum of 9” and a maximum of 11”. Any floral design or religious symbols must be placed on the opposite corner. The design cannot exceed past the center point of the monument, and for any carving of a religious symbol, theme or figure, the (full) niche must conform to present regulations;
- b. Designs of the same size and general theme may be repeated on the back of memorials of our lots and larger when the certificate holder has burial rights (as one lot on one certificate ) in front and back;
- c. In place of floral design, or in conjunction with floral design, a design exceeding no more that 1” in depth of a religious symbol such as an Angel, a Dove, approved religious symbol or theme will be permitted, such design may also be etched. Also permitted will be the crest or emblem of either a religious organization such as the Knights of Columbus, Knights of the Holy Sepulchre or a religious order; or the shield or emblem of a profession, such as the legal or medical. If a carved figure is used, there must be a ¼” border between niche and edge of stone. Sizes of figures not to exceed the following:

- 2’0” x 0’8” x 1’0” monument – 4” x 4”  
 1’8” x 0’8” x 2’0” monument – 6” x 6”  
 2’6” x 0’8” x 1’6” monument – 6” x 6” (only at Holy Rood Cemetery)  
 3’0” x 0’8” x 2’0” monument – 8” x 8”

d. A carved or etched bust of a religious figure, symbol or theme is regulated in size, depth, and placement each according to the permitted size of the monument. **When a center cross is not selected, crosses must appear to both the left and the right side of the religious carved or etched bust/figure/symbol or religious theme and follow all appropriate regulations as for centered cross placement.** If there is any question as to the size or subject of hand carving or etching design, a full size sketch must be submitted for approval. Below are the requirements listed by lot and monument size criteria.

Single Lot Monument (Width X Depth Height) 2’0”x 0x’8”x1’0”	MAX. SIZE (Width x Height)	MAXIMUM DEPTH	PLACEMENT
Religious Carved or Etched: bust/figure/symbol	4” x 4” maximum	2 ½”	Centered or at side(s)
Crosses (with rosary 1 ½” to 2”)	3” –3 ½”		Centered or both sides
Etched Religious Theme (eg. Safely Home)	Proportional		Centered or at side(s)

**MONUMENT & INSCRIPTION RULES AND REGULATIONS**

## Catholic Cemeteries : Diocese of Rockville Centre

<b>Single Lot Monument (Width X Depth X Height) 1'8"x 0x'8"x2'0" (Die/Monolith)</b>	<b>MAX. SIZE (Width x Height)</b>	<b>MAXIMUM DEPTH</b>	<b>PLACEMENT</b>
Religious Carved or Etched bust/figure/symbol	8" x 8" Centered 6" x 6" Side	2 ½ "	Centered Side
Crosses	6" – 9"		Centered or both Sides
Etched Religious Theme (eg. Safely Home)	Proportional		Centered or at side

<b>HR - Double Lot Monument (Width X Depth X Height) 2'6"x 0x'8"x1'6"</b>	<b>MAX. SIZE (Width x Height)</b>	<b>MAXIMUM DEPTH</b>	<b>PLACEMENT</b>
Religious Carved or Etched bust/figure/symbol	6" x 6" maximum	2 ½ "	Centered or Side
Crosses	4 ½" – 5 ½"		Centered or both Sides
Etched Religious Theme (eg. Safely Home)	Proportional		Centered or at side

<b>HR-QAS – HS -Double Lot Monument (Width X Depth X Height) 3'0"x 0x'8"x2'0" Die</b>	<b>MAX. SIZE (Width x Height)</b>	<b>MAXIMUM DEPTH</b>	<b>PLACEMENT</b>
Religious Carved or Etched bust/ figure/symbol	8" x 8" maximum	2 ½ "	Centered or Side
Crosses	6" – 9"		Centered or both Sides
Etched Religious Theme (eg. Safely Home)	Proportional		Centered or at side

<b>HS-QAS - Triple Lot Monument (Width X Depth X Height) 3'2"x 0x'8"x2'4" Die</b>	<b>MAX. SIZE (Width x Height)</b>	<b>MAXIMUM DEPTH</b>	<b>PLACEMENT</b>
Religious Carved or etched bust /figure/symbol	10" x 12" maximum	2 ½ "	Centered or Side
Crosses	6 " – 9"		Centered or both Sides
Etched Religious Theme (eg. Safely Home)	Proportional		Centered or at side

<b>HR-Triple Lot Monument (Width X Depth X Height) 3'2"x 0x'8"x2'0"</b>	<b>MAX. SIZE (Width x Height)</b>	<b>MAXIMUM DEPTH</b>	<b>PLACEMENT</b>
Religious Carved or etched bust /figure/symbol	10" x 12"	2 ½ "	Centered or Side
Crosses	6 " – 9"		Centered or both Sides
Etched Religious Theme (eg. Safely Home)	Proportional		Centered or at side

<b>HS - QAS – Four Lot Monument (Width X Depth X Height) 3'2"x 0x'8"x2'4"</b>	<b>MAX. SIZE (Width x Height)</b>	<b>MAXIMUM DEPTH</b>	<b>PLACEMENT</b>
Religious Carved or Etched bust/ figure/symbol	10" x 12"	2 ½ "	Centered or Side
Crosses	6" – 9"		Centered or both Sides
Etched Religious Theme (eg. Safely Home)	Proportional		Centered or at side

<b>HS - QAS – Four Lot Monument (Width X Depth X Height) 3'2"x 0x'8"x2'10" or 3'7" x 0'8" x 2'6"</b>	<b>MAX. SIZE (Width x Height)</b>	<b>MAXIMUM DEPTH</b>	<b>PLACEMENT</b>
Religious Carved or Etched bust/ figure/symbol	15" x 15"	2 ½ "	Centered or Side
Crosses	6" – 9"		Centered or both Sides
Etched Religious Theme (eg. Safely Home)	Proportional		Centered or at side

### MONUMENT & INSCRIPTION RULES AND REGULATIONS

**Catholic Cemeteries : Diocese of Rockville Centre**

<b>HR- Four Lot Monument (Width X Depth X Height) 3'4"x 0x'10"x2'10"</b>	<b>MAX. SIZE (Width x Height)</b>	<b>MAXIMUM DEPTH</b>	<b>PLACEMENT</b>
Religious Carved or etched bust /figure/symbol	15" x 15" maximum	5 ½"	Centered or Side
Crosses	8" – 12"		Centered or both Sides
Etched Religious Theme (eg. Safely Home)	Proportional		Centered or at side
For five lots and larger, all ornamentation and carvings must be in proportion to size of monument. Should any question arise to size or depth of subject, a full size sketch will be requested. (For Holy Rood Cemetery this regulation is for six lots and larger.)			

**AT NO TIME CAN THE ETCHINGS OF THE DECEASED BE PLACED CENTERED ON THE MONUMENT. THESE ETCHINGS ARE TO APPEAR ON THE SIDES.** Etchings of persons are permitted when limited to two (2) etchings per monument. Such etchings cannot exceed 4" x 4" and cannot be placed as the central symbol on the monument. **WHERE AN ETCHED LIKENESS OF THE DECEASED APPEARS ON THE MONUMENT'S SIDE, THE CROSS MUST BE CENTERED.** (Etchings must be of a deceased person buried within the lot. Pre-need etchings are not permitted).

**E) Stainless Steel Portraits**

The stainless steel portraits program requires completion of a separate application, that can be obtained from the cemetery office or the company's web site at [www.holyroodcemetery.org](http://www.holyroodcemetery.org). Additional specific approval information, changes, and specifications may appear on the cemetery application only rather than be included in this document at the time of publication.

**The criteria for Stainless Steel Portraits:**

- 1) Portraits must be made of stainless steel;
- 2) Portraits must be oval;
- 3) Portraits must be positioned vertical;
- 4) All Portraits are installed "flush mount" with 3M Adhesive Tape (VHB Y4951 or its equivalent).
- 5) Portrait background shall be a neutral color (no scenery).
- 6) Portrait shall be made full border (where the background extends off the sides of the portrait oval).
- 7) The final attire of the individual in the portrait shall be a traditional "Sunday Dress." Acceptable clothing for men: (1) formal wear (tuxedo), (2) jacket and tie, (3) shirt and sweater (w/o printed sayings or logos), (4) a button down dress shirt. Acceptable clothing for women: (1) formal wear (evening gown), (2) dress, (3) suit, (4) sweater (w/o printed sayings or logos), (5) a button down dress blouse. Hats or head coverings are recommended only when the subject's hat pertains to the profession and uniform. For example - a military dress uniform, police officer, firefighter.

**MONUMENT & INSCRIPTION RULES AND REGULATIONS**

## Catholic Cemeteries : Diocese of Rockville Centre

- 8) A size maximum for the program as a whole is 3 ¼” x 4 ¼”. Monument/Marker style and layout or design may require a smaller size than the maximum size permitted.

### **The limitations for Stainless Steel Portraits:**

- 1) Photo rings are prohibited;
- 2) Portraits shall not be recessed into the monument, marker, or memorial;
- 3) Covers as specified are required for Flush Markers and are prohibited elsewhere;
- 4) Only 1 or 2 subjects (persons) can appear in the portrait;
- 5) The subject must be a deceased human being buried in the burial space, or, if the subject is for pre-need placement verify required prior filing of pre-need inscription form/application, owner/survivor designation form;
- 6) Portrait appearance is limited to a bust or half figure;
- 7) No person shall appear in more than one portrait (this does not include approved etchings);
- 8) Monument must be inspected for size verification after receipt of the application and prior to accepting or placing an order with Catholic Cemeteries or an approved vendor;
- 9) Portraits may not be placed covering a design, pattern or carved line (or panel line) on the monument or memorial.

### **There are placement restrictions divided into three categories below:**

All placement should be 1 inch in from the side of the monument and the largest available size selected for the specified area of placement:

- 1) Above and to the Left or Right Side (never centered), or below (to the left or right) of the titled Surname. Size range from no smaller than 2 3/8” x 2 ¾” to no larger than 3 ¼” x 4 ¼”;
- 2) Next to or Above, to the Left or Right, of the deceased’s name when it appears as a one line inscription along with the dates. Size 1.18” x 1.57” or 1” x 1 3/8”;
- 3) Between the dates when the deceased’s name appears as a two line inscription with the dates on the second line. Size 1.18” x 1.57” or 1” x 1 3/8”;

### **Installation of a Stainless Steel Portrait**

The portrait with tape (preferably 3M VHB Y4951 two sided adhesive tape) must be installed on a flat clean surface at a temperature above 32 degrees Fahrenheit. Area must be cleaned with rubbing alcohol and then wiped dry with a clean cloth or paper towel. Once the portrait has been installed on the monument, apply pressure for approximately 2 minutes.

## MONUMENT & INSCRIPTION RULES AND REGULATIONS

## Catholic Cemeteries : Diocese of Rockville Centre

### 18. Color of Monuments:

*It has been observed that monuments with black coloring become easily scratched. The dark colors and light contrasts that make the stone attractive in a showroom setting, also make it somewhat unsuitable for use in a setting exposed to the elements, dust and dirt. It has also been noted that the polish of these monuments or the materials used during the polishing process to give a uniform color sometimes fade with time. Although at present time these monuments will still be permitted, for any "Black" monuments, including Keystone, Jet, Impala, or similar type colors, an affidavit must be submitted by the certificate holder indemnifying the cemetery from responsibility should scratches occur or if polish fades.*

- a. Ebony and Blue Pearl monuments are not recommended. These monuments have been permitted by special cemetery affidavit with the understanding and acceptance of the Certificate holder or heirs [affiant(s)] acknowledgement that the monument may become scratched or faded and indemnify and hold harmless the cemetery authorities of all responsibility regarding the monument's appearance;
- b. Coloring, pigmentations, enameling, gilding, bronzing or lithographing of lettering, floral designs or other parts of memorials is prohibited. Painting, gold leaf, or litho chrome accents to letters are not permitted;
- c. Replacements or additions to memorials must be of granite. When replacing a base or die, please verify the size and color of the existing memorial;
- d. Photographs and ceramic cameos of persons, living or deceased, may not be affixed on memorials or lots. Permitted are etchings (of a deceased person buried in this lot) when limited to two (2) etchings per monument. **Such etchings cannot exceed 4" x 4" and cannot be placed as the central symbol on the monument.** Stainless Steel portraits as approved by cemetery authorities may be installed on the surface (not inset) of cemetery monuments as prescribed by the program's regulations (including size, shape, finish, appearance, location or placement, and material composition).

### 19. Tolerances:

- Thickness:** For a monument up to eight (8) inches thick, a tolerance of ¼ inch over or ¼ inch under is permitted.  
For a monument up to ten (10) inches thick, a tolerance of ½ inch over or ½ inch under is permitted.
- Width:** For a single, double, and three grave plots, a tolerance of ¼ inch over or ¼ inch under is permitted.  
For four grave lots and larger, a tolerance of ½ inch over or ½ inch under is permitted.
- Height:** A tolerance of ½ inch over or ½ inch under is permitted.
- Design:** On 1'-8" x 0'-8" x 2'-0" monument – three inch space must be maintained between sandblast design and cross. A tolerance of 1/8" is permitted.

## **MONUMENT & INSCRIPTION RULES AND REGULATIONS**



## Catholic Cemeteries : Diocese of Rockville Centre

### **SPECIFIC REGULATIONS BY CEMETERY**

*Due to the continual changes in growth and development at each cemetery location and with the addition of new sections and at times products and services available at particular locations within the cemetery structure, each cemetery has maintained and published specific regulations of tolerances for monument thickness, width, height and design, size and type of monument/marker permitted by their respective location and site intent. Contact your local cemetery office for these details and to obtain an up to date set of specific regulations by area.*

#### **Sizes for Lawn Crypt Monuments**

##### Upright Monument plots:

Die: 1'8" width, 8" thickness, 2' height with a maximum of five lines (six lines with a base at Holy Sepulchre Cemetery) of inscription space for names, dates, and terms of endearment are permitted subject to space available by size and design of monument and by length of inscription. Two surnames in 2 1/2 " lettering are permitted when the certificate holder signs an affidavit to this effect. A two-line epitaph in the form of a prayer or a scripture text is permitted. Except for the aforementioned lettering and inscriptions, no other lettering, inscriptions or phrases are permitted.

##### Flush Marker plots:

The overall dimensions of the rectangular shaped marker including the granite base, can be neither less nor exceed a length of 28"; a width of 18"; and a thickness of 3" to 4". The bronze plaque, when considered separately, can be neither less nor exceed a length of 24" and a width of 14". The alloy used in creating the bronze plaque should consist of the following:

1. Copper: not less than 87%
2. Tin: not less than 5%
3. Lead: not less than 2.5%
4. Zinc: not less than 5%
5. All other elements not to exceed 1%

The granite base must be pink coloration (comparable to Salisbury pink), polished top, sawed sides, with its dimensions in conformation with those detailed above.

## **MONUMENT & INSCRIPTION RULES AND REGULATIONS**

**Catholic Cemeteries : Diocese of Rockville Centre**

**Sizes for Lot-site Monuments:**

<b>Single Lot Monument (Width X Depth X Height) 1'8"x 0x'8"x2'0"</b>			<b>PLACEMENT</b>
Inscriptions	Names and dates (century)	5	
At HS Inscriptions (where bases are permitted)	Names and dates (century)	6	
At HR – Crosses	6" – 9" minimum centered; 6" – 9" when both left and right; 9" – 11" side cross with no ornamentation or design in center		Centered, both Left and Right of the Center Design, as a side cross with no ornamentation or design in center
At HS – Crosses	6" – 9" minimum centered; 4 ½" – 5 ½" when both left and right; 9" – 11" side cross with no ornamentation or design in center		Centered, both Left and Right of the Center Design, as a side cross with no ornamentation or design in center
Family name	2 name maximum	2 ½"	From the bottom of the family name minimum of 11 " to joint
First Name			Commence 8" from joint
Epitaph	1 line, 2 line (aff. required)	when panel is used 10" from joint	9 ½" up from joint or bottom step of cross
Term of Endearment	Requires an affidavit	when panel is used 10" from joint	9 ½" up from joint
Roll Back Design		2" maximum	
At Holy Sepulchre Cemetery, where permitted, the base shall be 2'0" width, 10" depth, 8" height with smooth back, polished top (B/R/P).			

<b>HR Single Lot Monument (Width X Depth X Height) 2'0"x 0x'8"x1'0"</b>			<b>PLACEMENT</b>
Inscriptions	Names and dates	3	
Crosses	3" – 3 ½ " minimum (with rosary 1 ½" – 2")		Centered, both Left and Right of the Center Design, as a side cross with no ornamentation or design in center
Family name	2 name maximum	2 "	
First Name			Commence 5 ½" from joint
Epitaph (for slant markers)	1 line, 2 line (aff. required)		6 ¾" up from joint
Epitaph (for straight faced monuments)	1 line, 2 line (aff. required)		6" up from joint
Term of Endearment (slant marker)	Requires an affidavit		6 ¾" up from joint
Term of Endearment (straight monument)	Requires an affidavit		6 ¾" up from joint
Roll Back Design		2" maximum	

**MONUMENT & INSCRIPTION RULES AND REGULATIONS**

## Catholic Cemeteries : Diocese of Rockville Centre

<b>HS-QAS -Double Lot Monument (Width X Depth X Height) 3'0"x 0x'8"x2'0"</b>			<b>PLACEMENT</b>
Inscriptions	Names and dates	6 or 5*	
Crosses	4 ½" – 5 ½" minimum centered;		Centered, both Left and Right of the Center Design, as a side cross with no ornamentation or design in center
At HS - Crosses	6" – 9" minimum centered; 4 ½" – 5 ½" when both left and right; 9" – 11" side cross with no ornamentation or design in center		Centered, both Left and Right of the Center Design, as a side cross with no ornamentation or design in center
Family name	2 name maximum	2 ½"	With One Last Name it must be 11" up from joint
First Name			Commence 8" from joint
Epitaph (for one piece monuments)	1 line, 2 line (aff. required)	when panel is used 10" from joint	9 ½" up from joint
Epitaph (where bases are permitted)	1 line, 2 line (aff. required)	when panel is used 10" from joint	9 ½" up from joint
Term of Endearment	Requires an affidavit		9 ½" or 8" up from joint
Roll Back Design		2" maximum	
<b>*Inscriptions are 6 for monuments with Die and Base. Inscriptions are 5 for monuments as Die only.</b>			
<b><i>BASES -HS – where permitted the base shall be (Width X Depth X Height) 3'6" x 0'10" x 0'8" Polished Top, Smooth Back, Balance Rock Pitch</i></b>			
<b><i>Note: With exception of design, cross and family name, all other approved forms of memorialization are to be placed where interments are located.</i></b>			

<b>HR - Double Lot Monument (Width X Depth X Height) 3'0"x 0x'8"x2'0"</b>			<b>PLACEMENT</b>
Inscriptions	Names and dates	6	
Crosses	6" – 9" minimum centered; 6" – 9" when both left and right; 9" – 11" side cross with no ornamentation or design in center		Centered, both Left and Right of the Center Design, as a side cross with no ornamentation or design in center
Family name	2 name maximum	2 ½"	From the bottom of the family name minimum of 11" to joint
First Name			Commence 8" from joint
Epitaph	1 line, 2 line (aff. required)	when panel is used 10" from joint	9 ½" up from joint
Term of Endearment	Requires an affidavit	when panel is used 10" from joint	9 ½" or 8" up from joint
Roll Back Design		2" maximum	
<b><i>Note: With exception of design, cross and family name, all other approved forms of memorialization are to be placed where interments are located.</i></b>			

## MONUMENT & INSCRIPTION RULES AND REGULATIONS

## Catholic Cemeteries : Diocese of Rockville Centre

<b>HR – Slant Monument (Width X Depth X Height) 2’6x 0x’8’’x1’6’’</b>			<b>PLACEMENT</b>
Inscriptions	Names and dates	6	
Crosses	4 ½” – 5 ½” minimum centered		Centered, both Left and Right of the Center Design,.
Family name	2 name maximum	2 ½ ”	
First Name			Commence 8” from joint
Epitaph	1 line	when panel is used 8 1/2” from joint	8” up from joint
Term of Endearment	Requires an affidavit	when panel is used 8 1/2” from joint	8” up from joint
Roll Back Design		2” maximum	
<i>Note: With exception of design, cross and family name , all other approved forms of memorialization are to be placed where interments are located.</i>			

## MONUMENT & INSCRIPTION RULES AND REGULATIONS

## Catholic Cemeteries : Diocese of Rockville Centre

Triple Lot Monument (Width X Depth X Height) 3'2"x 0x'8"x2'0" HS - Triple Lot Monument (Width X Depth X Height) 3'2"x 0x'8"x2'4" (Axed, Steeled or polished)			PLACEMENT
Inscriptions	Names and dates	9 + *	
Crosses	6" – 9" minimum		Centered, both Left and Right of the Center Design.
At HS Crosses	6" – 12" minimum centered; 4 ½" – 5 ½" when both left and right; 9 "– 11" side cross with no ornamentation or design in center		Centered, both Left and Right of the Center Design, as a side cross with no ornamentation or design in center
Family name	2 name maximum	3"	With One Last Name it must be 11" up from joint
HS - Family (or first) name	2 name maximum	2 ½ " to 3"	With One Last Name it must be 11" up from joint
Hr - First Name			Commence 8" from joint
First Name	When no term of endearment is used	When no epitaph is used	From the bottom of the family name minimum of 11 " to joint
Epitaph	1 line, 2 line (aff. required)	when panel is used 10" from joint	8 ½" up from joint at HS 9 ½" up from joint
HS - Epitaph (where bases are permitted)	1 line, 2 line (aff. required)	when panel is used 11" from joint	11" up from joint
HS - Epitaph (where bases are permitted)	1 line, 2 line (aff. required)	No panel permitted	When placed ½" from joint
QAS - Epitaph (where bases are permitted)	1 line, 2 line (aff. required)	when panel is used 11" from joint	9 ½" up from joint
Term of Endearment	Requires an affidavit		9 ½" up from joint
Roll Back Design		2" maximum	
<i>* Additional inscriptions permitted where base is permitted.</i>			
<b><i>BASES -HS – where permitted the base shall be (Width X Depth X Height)</i></b>			<b><i>4'0" x 1'0" x 0'10"</i></b>
<b><i>Polished/Axed/Steeled. 1" Drop wash die centered on base</i></b>			
<b><i>BASES -QAS – where permitted the base shall be (Width X Depth X Height)</i></b>			<b><i>4'0" x 0'10" x 1'0"</i></b>
<b><i>Polished/Axed/Steeled</i></b>			
<b><i>1" Drop wash die even with back of base may use two 6" bronze dowels or stone epoxy.</i></b>			
<b><i>Note: With exception of design, cross and family name, all other approved forms of memorialization are to be placed where interments are located.</i></b>			

## MONUMENT & INSCRIPTION RULES AND REGULATIONS

## Catholic Cemeteries : Diocese of Rockville Centre

<b>Four Lot Monument (Width X Depth X Height) 3'4"x 0'10"x 2'10"</b> <b>At HS 3'2" x 0'8" x 2'4", at 3'2" x 0'8" x 2'10", or 3'7" x 0'8" x 2'6"</b> <b>Or (Width X Depth X Height) 2'3"x 0'10"x 4'0" Or</b> <b>Cross with Base as (Width X Depth X Height) Proportional x Proportional x 5'6"</b> <i>(where family owns lot on both sides of the beam)</i>			<b>PLACEMENT</b>
Inscriptions	Names and dates	12	
Crosses	8" – 12" minimum At HS a 6" – 12" minimum centered; 4 ½" – 5 ½" when both left and right; 9" – 11" side cross with no ornamentation or design in center		Centered, both Left and Right of the Center Design, as a side cross with no ornamentation or design in center
Family name	2 name maximum	3 "	With One Last Name it must be 16" up from
HS Family name	2 name maximum	2 ½" to 3 "	With One Last Name it must be 16" up from
First Name			Commence 12" from joint
HR - First Name	When no term of endearment is used	When no epitaph is used	Commence 10" from bottom of joint
Epitaph (for one piece monuments)	1 line, 2 line (aff. required)	10" maximum	When panel is used must be 14" up from joint or bottom step of cross
HS - Epitaph (where bases are permitted)	1 line, 2 line (aff. required)	10" maximum	When panel is used must be 14" up from joint or bottom step of cross
QAS - Epitaph (where bases are permitted)	1 line, 2 line (aff. required)	10" maximum	When panel is used must be 14" up from joint or bottom step of cross
Term of Endearment (straight monument)	Requires an affidavit		9 ½" up from joint
Roll Back Design		2" maximum	
<b><i>BASES -HS – where permitted the base shall be (Width X Depth X Height) 5'0" x 1'0" x 0'10"</i></b> <b><i>with a smooth back and a polished top (balance axed, steeled or polished). Die Centered.</i></b>			
<b><i>BASES -QAS – where permitted the base shall be (Width X Depth X Height) 5'0" x 0'10" x 1'0"</i></b> <b><i>Die flush with rear of base.</i></b>			
<i>Note: With exception of design, cross and family name , all other approved forms of memorialization are to be placed where interments are located.</i>			

**All stonework for five lots and larger will be approved subject to type and size of monument, the decoration or carving and the layout of said plot.**

## MONUMENT & INSCRIPTION RULES AND REGULATIONS

**Catholic Cemeteries : Diocese of Rockville Centre**

<b>HR - Six Lot Monument (Width X Depth X Height) 5'0"x 0 '10"x 2'10" (monolith)</b>			<b>PLACEMENT</b>
Inscriptions	Names and dates	18	
Crosses	8" – 12" minimum		Centered, both Left and Right of the Center
Family name	4 name maximum	3 "	
First Name			Commence 12" from joint
Epitaph (for one piece monuments)	1 line, 2 line (aff. required)	When a panel is used 13 ½" up from joint	14" panel up from joint or 13 ½" to top of Epitaph if no panel is used.
Term of Endearment	Requires an affidavit		13 ½" or 12" up from joint
Roll Back Design		Details submitted for approval	
<i>Note: With exception of design, cross and family name , all other approved forms of memorialization are to be placed where interments are located.</i>			

<b>HR - Six Lot Monument (Width X Depth X Height) 3'0" x 0 '10"x 5'7" BASE –required – (Width X Depth X Height) 3'6" x1'4" x 1'0" Statute in Niche</b>			<b>PLACEMENT</b>
Inscriptions	Names and dates	18	
Crosses			Recommended for reverse side of memorial opposite niche
Family name	4 name maximum	3 "	
First Name			
Epitaph (for one piece monuments)	1 line, 2 line (aff. required)		
Term of Endearment	Requires an affidavit		
<i>Note: With exception of design, cross and family name , all other approved forms of memorialization are to be placed where interments are located.</i>			

<b>HR - Six Lot Monument (Width X Depth X Height) 3'0" x 0 '10"x 4'6" BASE – required – (Width X Depth X Height) 3'6" x1'4" x 1'0"</b>			<b>PLACEMENT</b>
Inscriptions	Names and dates	18	
Crosses	8" – 12" minimum		Centered, both Left and Right of the Center
Family name	4 name maximum	3 "	
First Name			½" spacing throughout
Epitaph	1 line, 2 line (aff. required)	When a panel is used 10" up from joint	½" spacing throughout
Term of Endearment	Requires an affidavit		½" spacing throughout
<i>Note: With exception of design, cross and family name , all other approved forms of memorialization are to be placed where interments are located.</i>			

**MONUMENT & INSCRIPTION RULES AND REGULATIONS**

**Catholic Cemeteries : Diocese of Rockville Centre**

<b>HR - Six Lot Monument</b> <b>Cross (Width X Depth X Height) Proportional x Proportional x 7'</b>			<b>PLACEMENT</b>
Inscriptions	Names and dates	18	
Crosses			The monument itself meets the requirement
Family name	4 name maximum	3 "	Must appear on steps
First Name			Must appear on steps
Epitaph	1 line, 2 line (aff. required)		Must appear on steps
Term of Endearment	Requires an affidavit		Must appear on steps
Roll Back Design		Details submitted for approval	
<i>Note: With exception of design, cross and family name, all other approved forms of memorialization are to be placed where interments are located.</i>			

<b>HS - Six Lot Monument (with front &amp; rear gravesites)</b> <b>HS - Six Lot Monument (Width X Depth X Height) 3'2"x 0x'10"x2'4"</b> <b>(Balance Axed, Steeled or polished)</b>			<b>PLACEMENT</b>
Inscriptions	Names and dates	18	Where lots on same certificate are laid out head to head. Permitted on both sides of monument
Crosses	8" – 12" minimum centered; 4 ½" – 5 ½" when both left and right; 10" – 16" side cross with no ornamentation or design in center		Recommended for reverse side of memorial opposite niche
Family name	4 name maximum	3 1/2 "	
First Name			½" spacing throughout
Epitaph	1 line, 2 line (aff. required)		½" spacing throughout
Term of Endearment	Requires an affidavit		½" spacing throughout
<b><i>BASES -HS – where permitted the base shall be (Width X Depth X Height) 4'0" x 1'0" x 0'10"</i></b> <b><i>When a 10" depth die is selected,</i></b> <b><i>a base of (Width X Depth X Height) 4'0" x 1'2" x 0'10" is an acceptable alternate design.</i></b>			
<i>Note: With exception of design, cross and family name, all other approved forms of memorialization are to be placed where interments are located.</i>			

**MONUMENT & INSCRIPTION RULES AND REGULATIONS**



**Catholic Cemeteries : Diocese of Rockville Centre**

<b>HS - Six Lot Monument (standard lot lay out)</b> <b>HS - Six Lot Monument (Width X Depth X Height) 6'0" x 0'10" x 3'0"</b> <b>(Axed, Steeled or polished)</b>			<b>PLACEMENT</b>
Inscriptions	Names and dates	18	Not permitted on rear of monument
Crosses	8" – 12" minimum centered; 4 ½" – 5 ½" when both left and right; 10" – 16" side cross with no ornamentation or design in center		Centered, both Left and Right of the Center
Family name	4 name maximum	3 1/2"	
First Name			½" spacing throughout
Epitaph	1 line, 2 line (aff. required)		½" spacing throughout
Term of Endearment	Requires an affidavit		½" spacing throughout
<b><i>BASES -HS – where permitted the base shall be (Width X Depth X Height) 7'0" x 1'2" x 0'10"</i></b>			
<b><i>Note: With exception of design, cross and family name, all other approved forms of memorialization are to be placed where interments are located.</i></b>			

Eight Lots (as specified): for twenty-four inscriptions of names and dates  
Numerous Variations for this plot size Maximum Dimensions:

	Width	Height	Thickness
Base	6'8"	1'0"	1'8"
Die	5'0"	2'5"	10"
-or-			
Base	4'6"	1'0"	1'8"
Die	3'8"	4'8"	10"
-or-			
Upright Monument with Wings			
Overall Dimensions	6'	5'6"	12"
-or-			
Cross 8' high with base in proportion.			

4" surnames will be permitted.

Twelve Lots (as specified): for thirty-six inscriptions of names and dates  
Numerous Variations for this plot size Maximum Dimensions:

	Width	Height	Thickness
Base	8'	1'	20"
Die	7'	3'	12"
-or-			
Statute or upright die overall	8'6"	8'0"	2'6"
(Base proportional to Die)			
-or-			
Cross (10' high Base proportional to Die)			

Surnames to be reviewed with proposal.

**MONUMENT & INSCRIPTION RULES AND REGULATIONS**

**Catholic Cemeteries : Diocese of Rockville Centre**

Eighteen Lots (as specified): for fifty-four inscriptions of names and dates (century)  
Numerous Variations for this plot size Maximum Dimensions:

	Width	Height	Thickness
Base & Die	13'	5'4"	1'6"
-or-			
free standing (with base)	5'6"	9'0"	2'6"
-or-			
Upright with Wings	10'0"	8'0"	2'6"
-or-			
Cross	12' overall height, with base proportional.		

Surnames to be reviewed with proposal.

**Shrine Sections (Flush Marker Lot sites):**

A bronze marker on a granite base of pink coloring is permitted in the shrine section. The general regulations are as follows:

Marker	Bronze Alloy must meet these standards: Copper: not less than 87% Tin: not less than 5% Lead: not less than 2.5% Zinc: not less than 5% All other elements not to exceed 1%
Size:	24" x 14" with round bouquet holder.
Finish:	Light (Matthews) Medium (Sheidow)
Inscriptions:	Layout must allow space for three inscriptions of names and dates.
Cross:	3"
Anchors:	Threaded bolts
Granite:	Color: Pink (comparable to Salisbury pink) Composition: Must be sawed all sides, top polished. Size: 28" x 18" x 3" to 4"

Government markers shall be permitted in Shrine Sections; however, these markers by design cannot and will not be altered to provide a bouquet holder for flowers.

**MONUMENT & INSCRIPTION RULES AND REGULATIONS**

## Catholic Cemeteries : Diocese of Rockville Centre

### Children Sections (Flush Marker Lot sites):

A bronze marker on a granite base of pink coloring (comparable to Salisbury Pink) is permitted in these sections. The general regulations are as follows:

Marker	Bronze Alloy must meet these standards: Copper: not less than 87% Tin: not less than 5% Lead: not less than 2.5% Zinc: not less than 5% All other elements not to exceed 1%
Size:	16" x 8" (bouquet holder not permitted).
Finish:	Light (Matthews) Medium (Sheidow)
Anchors:	Threaded bolts
Granite:	Color: Pink (comparable to Salisbury Pink) Composition: Must be sawed all sides, top polished. Size: 20" x 12" x 3" to 4"

### Crypt and Niche Features

The cemetery management exclusively provides bronze features and a select number of emblems for crypt and niche fronts (where approved). For price, selection, and installation location of these products, please contact the cemetery office for further details.

## **INSCRIPTION REGULATIONS**

All inscriptions will be limited to the inscription space available on each size monument, and layout must allow for as many inscriptions as burial space was designed and intended in the lot holding. Any layout that does not allow for the maximum number of inscriptions must be accompanied by an affidavit from the Certificate holder confirming that he/she realizes that such layout will limit the number of inscriptions. The following inscriptions are permitted, provided they conform to the general rules:

1. Dates of birth and death, first name and middle initial.
2. Suffix and Prefixes such as Sr., Jr., M.D. or honorary title such as K.C., H.S., or K.H.S. permitted after name.
3. First name and full middle name or surname permitted. Maiden name or dual surnames where names conform to available space and lay out.
4. Approved epitaph or term of endearment is permitted.

## MONUMENT & INSCRIPTION RULES AND REGULATIONS

## Catholic Cemeteries : Diocese of Rockville Centre

5. The following general rules apply:
  - a. All newly added lettering must conform to existing lettering in size and style, except where rule change necessitate a variation.
  - b. Names are to be 1" – Dates are to be ¾" and normally are one-line inscriptions.
  - c. Lettering may be outlined frosted, shallow frosted or deep sunk if monument is polished; V-sunk if monument is axed. No paneling of surnames, individual names or dates.
  - d. Most inscriptions of full last names in 1" lettering may require the omitting of a date or dates, or placing the inscription on two lines that could eliminate an inscription space.
  - e. The designated "inscription area" (See chart in following section) must allow for space between sides of stones and other inscriptions.
6. Any questions as to available space will require the submittal of a full sketch; the decision of Cemetery Authorities is final.
7. On all size lots, additional inscriptions of surnames in large letters will be permitted with proper affidavit. Surnames may be placed next to each other (for short family names) or one below the other. All other regulations regarding lettering sizes and locations must be followed.
8. At the Cemetery of the Holy Rood, on a 2'6" x 0'8" x 1'6" double lot stone, an approved epitaph in ¾" lettering may be placed at a height of 8 ½" to top. Epitaph must be centered on the monument with inscriptions of names and dates below.
9. Certificate holders are required to given their written consent, via a cemetery affidavit, to permit a different surname as a title name (in large letters) on a monument.
10. Epitaph in ¾" lettering is permitted 9 ½" from bottom of 1'8" x 2'0" single monument, and a 3'0" double monument, or it may be placed on bottom step of cross. Except Holy Rood Cemetery on three lots and larger, it is placed on dies, just above joint.
11. On four lot plots and larger, inscriptions are permitted on front and rear of monuments, when holder of Certificate has right of burial in both front and rear. If inscription is being placed on existing monument, cross must be present on rear of monument (At Holy Rood for four lot plots and larger).
12. On four and six lot plots, the top inscription of names and dates may be placed at a maximum height of 12". This will enable three inscriptions per lot of names with dates below if desired.
13. A minimum of ½" space must be left between all inscriptions of first names, surnames, cross and panel.

## MONUMENT & INSCRIPTION RULES AND REGULATIONS

**Catholic Cemeteries : Diocese of Rockville Centre**

14. In place of century years of birth and death, full dates on the form of “Feb 1, 1991” or “2/1/91” are permitted. Should format require the placement of dates below, affidavit will be required limiting an inscription space.

15. On all size monuments (subject to space available) terms denoting family relationships (e.g. beloved husband, devoted wife, beloved son) will be permitted. An affidavit is required allowing for either of the following:

- a. Inscriptions of first names and dates will be limited to three per lot with two terms of endearment permitted, or;
- b. No other epitaphs are permitted;
- c. Affidavit is required.

Example ( for all lot site except 1’8” x 8” x 2’0”)

¾” Beloved Husband	(space)
1900 John H. 1982 ¾” and 1”	1900 Fredrick 1983
¾” Beloved Wife	(space)
1900 Mary 1983 ¾” and 1”	1910 Jane 1983

For Holy Rood Cemetery:

<u>Size of Plot</u>	<u>Size of Monument</u>	<u>Max. number of caskets*</u>	<u>Max. Width of Each Inscription</u>	<u>Height to top of 1<sup>st</sup> Inscription</u>
Single	2’0” x 0’8” x 1’0”	3	12”	5 ½” slant faced 5” straight faced
	1’8” x 0’8” x 2’0”	3	20”	8”
Double	2’6” x 0’8” x 1’6”	6	15”	8”
	3’0” x 0’8” x 2’0	6	18”	8”
Triple	3’2” x 0’8” x 2’0”	9	12 2/3”	8” width epitaph 10” width epitaph
Four Lots	3’4” x 0’10” x 2’10”	12	20”	12”
	2’3” x 0’10” x 4’0”	12	13 1/2”	12”
	Cross	12	According to size of base.	

Six Lots & Larger regulated by design and size of monument.

\* When family intends to provide additional burial space for cremated remains the memorial design and inscription layout must accommodate these additional inscriptions.

**MONUMENT & INSCRIPTION RULES AND REGULATIONS**

## Catholic Cemeteries : Diocese of Rockville Centre

For all other Cemeteries:

<u>Size of Plot</u>	<u>Size of Monument</u>	<u>Max. number of Caskets *</u>	<u>Max. Width of Each Inscription</u>	<u>Height to top of 1<sup>st</sup> Inscription</u>
Single	1'8" x 0'8" x 2'0"	3	20"	8"
Double	3'0" x 0'8" x 2'0"	6	18"	8"
Triple (Base)	4'0" x 0'10" x 1'0"	9	16"	11 ½"
Four Lots (Base)	5'0" x 0'10" x 1'0"	12	15"	11 ½"

Five Lots & Larger regulated by design and size of monument.

\* When family intends to provide additional burial space for cremated remains the memorial design and inscription layout must accommodate these additional inscriptions.

16. On two lot plots and larger, inscriptions must match form of inscriptions on other lots, that limit these as well.

17. The cemetery management, under agreement with a monument inscription firm, will complete all inscriptions at the cemetery's community mausoleums. Monument dealers and inscription work companies are prohibited from contracting or accepting this work from any family member or Certificate holder.

18. For Lawn Crypts, Bronze Marker or Monuments and/or Bouquet holders are the only lot markers permitted.

19. The cemetery can provide a list of approved epitaphs upon request. Any epitaph not on this list must be submitted to the Cemetery Management for approval. In general, epitaphs must be from Scripture, prayers, or religious hymns, and must readily and apparently express Christian virtues.

### **SETTING AND INSCRIBING MONUMENTS**

1. Monument setters and inscribers are to complete work as stated on the filed application at the cemetery office. If the monument or inscription order you received does not match our filed permit exactly **do not start the work**. The work must be postponed until an amended application is filed approved, and a fee is collected.

## MONUMENT & INSCRIPTION RULES AND REGULATIONS

## Catholic Cemeteries : Diocese of Rockville Centre

2. Work may be done in the cemetery (weather permitting) from Monday to Friday, between the hours of 8:00 A.M. and 3:45 P.M. Contractors are advised that all personnel, trucks and equipment must be out of the cemetery at all other times. No work is permitted on Saturdays, Sundays, and Holidays. Work is also prohibited from Holy Thursday through Easter Sunday, nor from the Thursdays immediately preceding Mother's Day and Father's Day through the respective Sundays, nor the day prior to Christmas Day and New Year's Day.
3. No memorials are to be set unless the temperature is 40 degrees Fahrenheit or above.
4. Permits for all work (including inscriptions and the setting or removal of monuments) must be obtained at the cemetery office before any work is started. All monuments shall be inspected for compliance on the monument truck prior to being removed for setting.
5. All monument work is to cease in the vicinity of a funeral until after the funeral cortege leaves the area of the interment. Vehicles used by monument dealers or setters are not to be parked in the area while the funeral is in progress.
6. Under no circumstance or at any time are monument workers to consume alcoholic beverages within the confines of the cemetery or are they to bring such beverages within the confines of the cemetery. Any monument worker who appears to be under the influence of alcohol or drugs will not be permitted to set.
7. The cemetery staff will also inspect all monuments post setting. The cemetery management does not accept monuments until the inspection process is complete. If a monument is required to be re-set. The work will be completed without cost to the cemetery or the plot holder. Damaged monuments and/or monuments set in violation of the cemetery's *rules* (or if deemed unsafe) will be removed by the cemetery staff at the expense of the monument dealer or setter. A letter will be forwarded to the monument dealer for correction or repair. The family will also be notified of this process.
8. The Cemetery staff will retain permits (for new monuments or inscriptions or other work on existing monuments) after the work is completed.
9. All stonework must be completed the day the permission is granted. If the work is not completed, the cemetery office must be notified the same day permission is granted.
10. The bottom of the base must be squared sufficiently to allow it to rest firmly on the foundation in a bed of mortar. The monument setter is obligated to supply these materials and perform this task. The top of the stone must pass a "Level Inspection Test" conducted by cemetery personnel. The cemetery will also conduct a safety examination at the time of setting the memorial.

## MONUMENT & INSCRIPTION RULES AND REGULATIONS

## Catholic Cemeteries : Diocese of Rockville Centre

11. Persons engaged in erecting monuments or other structures are prohibited from attaching ropes, wires or other equipment to trees, shrubs or monuments, and from scattering their equipment over adjoining areas, or leaving the same on the grounds any longer than is necessary. They shall leave the area in a clean condition.

12. The Monument setter should “wash” the monument till it remains free of setting compound and /or debris. Monument setters are required to protect lawn areas and plantings at the lot site during the entire setting and cleaning process.

13. The Cemetery reserves the right to remove any memorial that is in a dangerous condition or which is detrimental to the general appearance of the Cemetery. Upon inspection, the cemetery reserves the right to remove any memorial in violation of the *Monument Rules and Regulations*.

14. A detailed plan and design of a memorial must be submitted to the Cemetery Management for approval before a permit will be issued, and no memorial shall be erected or placed until checked, approved and accepted by the Cemetery.

15. The erection or removal of a monument or an inscription on a memorial may be made only upon the presentation of the following:

- a The original of the Certificate. Photocopies are not acceptable;
- b If the original Certificate is not available, the Duplicate Certificate of Right of Burial (Duplicate Certificate). Photocopies are not acceptable;
- c In place of the Certificate or Duplicate Certificate, an affidavit duly executed by the original Certificate holder or, if the original Certificate holder is deceased, by his or her heirs at law;
- d In case of removal of a monument, in addition to the Certificate or Duplicate Certificate, a properly executed affidavit signed by the Certificate holder or, in the event the Certificate holder is deceased, by the heirs at law of the Certificate holder;
- e Payment of Annual Care charges due.

16. The cemetery will only be responsible for damage caused by cemetery personnel and equipment. The cemetery has the right to determine liability and the cemetery reserves the right to repair a memorial damaged by cemetery personnel.

17. The texts of all inscriptions are subject to approval of the Cemetery Management. On all applications, foreign language inscriptions must be accompanied by an English translation of the inscription. All applications for inscription must include the size of the inscription.

18. Painting, gold leaf, or litho chrome accents to letters are not permitted.

19. The cemetery will not approve or permit memorial and inscription work until annual care charges are paid in full. The cemetery will also require full payment by certified check, bank check, bank debit card, or by mastercard and visa credit card for any uncollected funds due prior to issuing an approval for stonework.

### MONUMENT & INSCRIPTION RULES AND REGULATIONS



## Catholic Cemeteries : Diocese of Rockville Centre

### MONUMENT MAINTENANCE SERVICE

In addition to the natural staining causes of memorials, today's industrialized economy with its airborne pollutants has increased the problem of dirty, grimy memorials at an increasing rate.

Catholic Cemeteries feels strongly that a clean monument not only enhances the natural qualities of the granite -but will add to the over-all beauty of a well-kept cemetery.

While it might be the intentions of the Certificate-holder of the memorials to keep it clean, it is generally agreed that over the years this does not take place.

We therefore recommend to the Certificate-holder and their heirs to consider the Cemetery's Monument cleaning program.

The cemetery staff can help clean the following types of stains from your family monument:

#### *Types of Stains*

*Moisture Stains, Oil and Grease Stains surrounding area,*

Organic Stains, Rust or Years of Accumulated Dirt, Other stains

#### Problems with the stains

Dark in color than the surrounding area. Grain of granite can be seen through stain. "New" moisture appears to be quite translucent.

Darker or blacker in color than grain of granite can be seen through. Stain appears to be more translucent and glossy. Turns yellow in color after a period of time.

Trees, Flowers, Birds, & Animals can all stain monuments. Dark in color.

Yellowish or brown in color on the surface of the granite. Iron Deposits absorbed into granite's finish.

Adhesive -Moisture trapped by glue from labels, tags, stickers. Food and Tobacco stains.  
Salt - White appearance, traces of crystals. Acid burns - lighter in appearance than surrounding areas.

Paint - noticeable color change.

## MONUMENT & INSCRIPTION RULES AND REGULATIONS

## Catholic Cemeteries : Diocese of Rockville Centre

### **Why have this service completed by Catholic Cemeteries?**

- Any cleaning process used on granite is time consuming.
- It is the type of work that should not be rushed.
- Knowledge of cleaning products is essential.
- The cleaning product itself can damage the granite's finish.
- The strength of some cleaning products can be dangerous
- Certain acids used in cleaning are flammable, hazardous and can injure the user or damage plants and grass if improperly used.
- Proper tools and clean up procedures must be followed.

Pricing Information is published separately contact the cemetery office for authorization and other details. Service is subject to weather conditions

### **FAMILY MAUSOLEUM AND UNDERGROUND VAULTS**

It is the intention of Family Mausoleum and Underground Vault specifications to cover the full furnishing, erection, and completion of the mausoleum, in a thoroughly good, craftsmanship manner, and the Contractor realizing the special nature and purpose of this work agrees to give personal, careful, supervision throughout the duration of the construction process.

### **ENDOWMENT CARE FOR FAMILY MAUSOLEUMS**

**ENDOWMENT CARE** - consists of the income received to provide for the care of the mausoleum interior in perpetuity and as such is subject to legal provisions that apply to trust funds requiring that the principal be invested in order to provide income for care of the endowed item. Care standards are set based on income available. Income in excess of care costs shall be retained, reinvested for the continued maintenance, repair or renovation of the endowed item.

## MONUMENT & INSCRIPTION RULES AND REGULATIONS

**Catholic Cemeteries : Diocese of Rockville Centre**

**GENERAL RULES**

1. All FOUNDATION designs are to be approved by cemetery management. The cemetery personnel install all foundations. The cemetery shall specify the depth of the excavation and the foundation. The cemetery management will provide a flat perimeter foundation according to the dimensions furnished by the monument contractor. No foundation work shall commence until the following conditions shall have been met:
  - a. Full plans and specifications in triplicate shall be submitted to the cemetery office for approval by the Cemetery Management. Should anything conflict with the *Monument Rules and Regulations* of the cemetery, the contractor, at the contractor's expense, will be required to submit revised plans, as requested by Cemetery Authorities;
  - b. Estimates (or price quotations) for foundation prices, Permanent Maintenance Costs for lawn, Endowment Care for the mausoleum building, and landscaping, and all other fees are subject to change without notice;
  - c. The contractor shall pay in full the cemetery's foundation charges prior to start of foundation's excavation. The Certificate holder shall pay in full the mausoleum's endowment care charges;
  - d. The contractor's Certificate of Insurance must be filed with the cemetery office upon request;
  - f. There will be a minimum of 30-day cure period after the foundation has been completely poured and before the construction permit can be issued;
  - g. Foundations are poured to established grade level.
2. The plot location numbers must be inscribed on the right side of the cover on underground vaults and on the right side of mausoleums.
3. A payment sufficient for the Permanent Maintenance of mausoleums or underground vaults must be made into the Permanent Maintenance Fund before a permit for construction will be issued. The amount required for mausoleums shall be based on the exterior cubic content of the building.
4. Persons engaged in constructing vaults are prohibited from attaching ropes, wires, or other equipment to trees, shrubs or monuments, and from scattering their equipment over adjoining areas, or leaving the same on the grounds any longer than is absolutely necessary. They shall leave the area in a clean condition free of all wood and materials.
5. Mausoleums or over-ground vaults shall occupy not more than eighty percent (80%) of the plot. The Management of the Cemetery shall designate the site. The Cemetery Management will determine the N-S-E-W direction of the mausoleum to be placed.
6. The cemetery requires a three-foot set back from the perimeter of the mausoleum site for the placement of the foundation.
7. The Cemetery Management shall designate the layout of any future burial ground around the mausoleum.

**MONUMENT & INSCRIPTION RULES AND REGULATIONS**

## Catholic Cemeteries : Diocese of Rockville Centre

8. A survey with existing elevations indicating the grade of the plot will be furnished upon request by the cemetery management. It is important that the mausoleum be designed to conform to the established lot grade.
9. The perimeter walls of the foundations shall be not less than 1' - 6" in thickness and not less than 6' deep. Interior walls for the support of crypts, floors, etc., shall not be less than 10" in thickness, or less than 4' deep.
10. All material shall be new, and the best quality of their respective kinds, and all workmanship of the highest grade. Any materials not coming up to the standard of the Specifications and Plans, in their true meaning and intent, shall be removed and replaced with proper materials by the Contractor, at the contractor's expense, as soon as possible. The Material used in the exterior of the mausoleum shall be approved granite from an established quarry. The granite should be of the best quality; free from cracks, iron, sap, knots, seams, or other defects and/or objectionable characteristics. All the granite in the building shall be from the same quarry and of the same run of stone. However, an exception may be made where contrasting colors are desired. When such a concession is requested, the color, trade name, and source of granite must be specified in the plan. All stones are to be cut with full beds and joints; all miters, arises, returns, and angles are to be sharp and true. The top surfaces of projecting stones are to be cut with sufficient wash or pitch to properly drain. All craftsmanship is to be first class in every particular. All carving indicated shall be first class, taken from full size details, approved by the Certificate holder, or Certificate holder representatives, and/or models, approved by the Owner, or Owner's representatives. Marble, limestone and other free stones are strictly prohibited in the construction of the exterior of the building.
- The roof shall consist of not more than 3 pieces. Structural Steel and Timber beams for supporting the roof are prohibited. If the pitch of the roof is 45 degrees or greater the outside pieces are to be doweled by using 1" round by 3" bronze dowels, 12" on center throughout the sidepiece. The base course shall not be less than 1 1/2" in thickness. Wall ashlar shall be not less than 8" in thickness from the pitched line. Where the walls are to be axed or polished the minimum width is 8". Joints between the foundation and the granite must be completely filled with a 1 to 4 mixture of cement and sand. All exterior joints (granite to granite, granite to marble, doors, and windows) shall have a level dressed bed to allow for a good bond between pieces, and shall be sealed with an approved sealant (e.g. Sica or G.E.) and backing material (closed cell styrafoam), and shall be completely pointed. The color of the sealant must match the foundation or granite (preferably white or gray medusa).
11. A cross as a religious symbol must appear on all mausoleums in a prominent position. Secular symbols must be approved by the cemetery management and will only be approved if they remain secondary to the religious symbol in size and position. Cemetery management must approve all symbols.
12. Steps if more than one piece, shall be set so that one laps over the other by not less than one inch.

## MONUMENT & INSCRIPTION RULES AND REGULATIONS

## Catholic Cemeteries : Diocese of Rockville Centre

13. Granite is recommended for the interior of the mausoleum. If marble is desired, the sidewalls shall be not less than 1 ½” in thickness. Ceiling slabs shall be securely anchored to the roof. Marble type is subject to the approval of cemetery management. All marble must be free of any imperfections that would impair its proper use and appearance in the mausoleum. Marble shall be in accordance with samples. All exposed interior surfaces are to be polished and free from any blemishes, and all edges are to be squared and true.
14. Plaster of Paris for setting interior work is not permitted.
15. Where granite floors shall be permitted, the thickness shall not be less than 8”.
16. All crypts shall have full shelves both top and bottom. Crypts shall be numbered, as directed by the Management, in the lower rear corner of the Tablets. Interments in crypts shall be made in soldered zinc lined box with a lead pan (hermetically sealed). Crypts should not be less than 7’ 8” long, 32” wide, and 26” high in the clear. The cemetery would prefer that granite or concrete be used for interior crypts. If slate is used, the size of the slate for crypts shall be: Rear, 1” in thickness; ends, 2” in thickness; shelf, 2” in thickness. The shelf shall be set to rest on the two ends and rear slates. If shelves are to be of concrete the width of the supports on the two ends and the rear, must be 2”. At least 1” of air space shall be provided between the inside face of the granite walls and the marble slate construction of the interior of the building. Crypt fronts shall not be less than 1 ½” in thickness, unless the crypt is open end type in which case the closing slab shall not be less than 1 ¼” in thickness. Stiles or crypt jams shall measure not less than 3 inches on the face, and the thickness shall be 1: more than the tablet or closing slab that it retains. Marble crypt sills shall be rabbited and pinned to fit corresponding rabbit in shelves. Contractor shall furnish and set bronze rosettes for each crypt tablet, and two lifting handles to fit the rosettes.
17. The aisle shall be not less than 8’ 2” long, and not less than 3’ 2” wide.
18. Doors must be entirely of U.S. standard bronze and shall open outward. When doors are opened, the opening shall not be less than 36” wide in width. Doors, whether cast or fabricated from sheet metal; must be sheathed on the rear. The exterior or front of the bronze door shall be made from a single sheet of metal. All openings or panels shall be cut out of this sheet. Joints are strictly prohibited. Glass windows shall be set that they may be opened independently of the doors. Door saddles must be of bronze.
19. Contractor shall furnish and set Bronze Window frame. The same to have inner portion removable, and made to contain art glass window and protection glass plate. No stained glass windows shall be set until the design and subject has received the approval of the cemetery’s Management. All windows in the mausoleum must have a protective polycarbonate cover such as a Lexan. Window frames shall be of bronze and must be set with the same approved sealant used in the granite joint work.

## MONUMENT & INSCRIPTION RULES AND REGULATIONS

## Catholic Cemeteries : Diocese of Rockville Centre

20. Altars are permitted subject to the approval of the cemetery's Management. The altar shall be designed so that it will not interfere with entombments.
21. Drawings submitted for approval must indicate exactly the nature of all symbolism, religious or otherwise. The Management is to be the sole judge of the appropriateness and propriety of it.
22. Suitable bronze ventilating grills shall be furnished and set, fitted to ventilating ducts cut through the granite walls. The back of each Ventilator shall have heavy mesh (Bronze), and watershed attached to it.
23. Upon completion of the mausoleum, two keys shall be left at the Cemetery Office. The cemetery reserves the right to access all mausoleums.
24. Duplication of mausoleums in style and design is prohibited in the same locality. The cemetery management reserves the right to make this distinction.
25. No contractor or their employees will be permitted to do any work or to deliver any materials in the Cemetery on Saturdays, Sundays or Holidays; or before 8:00 A.M. or after 4:00 P.M., on weekdays. Work may be done in the cemetery (weather permitting) from Monday to Friday, between the hours of 8:00 A.M. and 3:45 P.M. Contractors are advised that all personnel, trucks and equipment must be out of the cemetery at all other times. No work is permitted on Saturdays, Sundays, and Holidays. Work is also prohibited from Holy Thursday through Easter Sunday, nor from the Thursdays immediately preceding Mother's Day and Father's Day through the respective Sundays, nor the day prior to Christmas Day and New Year's Day.
26. Persons engaged in erecting mausoleums or other structures are prohibited from attaching ropes, wires or other equipment to trees, shrubs or monuments, and from scattering their equipment over adjoining areas, or leaving the same on the grounds any longer than is necessary. They shall leave the area in a clean condition. **Contractors are prohibited from using cemetery equipment and materials (including scaffolding and ladders).**
27. Changes in design, color, and materials must be submitted in triplicate specifying the change(s). Changes shall be reviewed and approved by the cemetery's Management.
28. In the event, construction begins and the contractor and/or Certificate holder decide to discontinue the construction process, refunds for foundation fees, Permanent Maintenance, and the mausoleum site and Permanent Maintenance will be granted under the following conditions:
  - a. The area is restored to its original state;
  - b. The Certificate holder completes the required cemetery prepared refund affidavits and surrenders the certificate as outlined in the Cemetery's General Rules and Regulations;

## MONUMENT & INSCRIPTION RULES AND REGULATIONS

## Catholic Cemeteries : Diocese of Rockville Centre

- c. The refund will be sent to the Certificate holder (not the contractor or payee). Administrative fees, Engineering fees, Restoration Costs, Waste Disposal Costs and any other costs incurred by the cemetery shall be subtracted from the refund.
29. The cemetery shall only be responsible for damage to mausoleums and underground vaults that is caused by cemetery personnel or equipment. The cemetery has the right to determine liability and the cemetery has the right to repair any mausoleum or underground vault.
30. The cemetery does not open private underground vaults or private mausoleum crypts for entombment. It is the responsibility of the Certificate holder or funeral director to arrange for access to the crypt for entombment.
31. Foundation design should include re-bar and PSI requirements.
32. A complete set of drawings and specification shall be maintained at the work site and at the cemetery office throughout the construction process. These drawings shall be made readily available to the Owner, Owner's representatives, Cemetery Management, and governing officials upon request. Blue Print submission should consist of Front Elevation, Side Elevation, Rear Elevation, Plan View, Longitudinal Section, and Transverse Section. Blue Print should include manufacturer and/or contract information along with date and revision notations. The contractor and specifications are to coordinate. Anything shown on the plan, and not to mention in the other, or vice-versa, or reasonably implied, that is necessary for the proper execution of said work, shall be furnished and performed by the contractor without additional expense to the Plot holder. The drawings are made to a uniform scale, marked thereon, but where figures are shown, they shall take precedence over scale dimensions in the construction of the work. The drawings and Specifications, are to be carried out in working, and in spirit, and are intended to cover the labor and materials necessary for the full completion of the work. The Contractor shall make no changes in any particular, except upon written notice of Owner, stating the amount to be allowed by the Contractor, or paid by Owner, covering such changes as may be agreed upon with the written approval of cemetery authorities.
33. Review *Rules and Regulations* for monument contractor obligations for vault and crypt openings.
34. Contractor shall be subject to a per diem fee for each day beyond the scheduled completion date.
35. Contractor, at their own expense, will promptly dispose of all crates, cartons, and other materials, once having served their purpose, must be removed from cemetery grounds leaving site and adjoining areas clean and free of debris.

## MONUMENT & INSCRIPTION RULES AND REGULATIONS

## Catholic Cemeteries : Diocese of Rockville Centre

36. Planks, furnished by the contractor, must be used to protect sod/turf and irrigation system in all cases at all times where heavy equipment is to be used in the lawn area. Since the lawn area of a Mausoleum construction site extend to adjoining plots a re-sod charge must be pre-paid. This fee will be incorporated into the foundation fee charge.

37. The Contractor must comply with, and be governed by, all laws, ordinances, or Monument Rules and Regulations applying to the premises, and the work thereon, and shall pay for all necessary permits.

38. The contractor shall save and protect the Certificate holder and the Cemetery entity from liability for all penalties and damage, to persons, or to the property of the cemetery, that may occur through any act of carelessness on the part of contract or contractor's employees during the construction of the work. The Contractor shall maintain, at contractor's own expense, Liability Insurance, Workers Compensation Insurance, Automotive and Equipment Insurance.

39. The contractor, and all subcontractors, shall be subject to the supervision and direction of cemetery management and cemetery management representatives throughout the construction process.

40. The contractor shall furnish Owner, Owner Representatives, and the Cemetery Management with samples of the material to be placed into the mausoleum, each sample showing their respective finish, as it will function in the work.

41. The contractor shall furnish Owner, Owner Representatives, and the Cemetery Management with a Certificate of Guarantee is to be furnished from the granite and marble quarries showing all materials used therein were of the quality provided for in the specifications and plans.

### **MODIFICATIONS AND AMENDMENTS**

1. Because of continuing changes in customs, practices, economic conditions, services and products, Catholic Cemeteries may, and hereby expressly reserves, the right at any time or times, with or without notice to Certificate holders, to adopt new *Monument Rules and Regulations*, or amend, alter and/or repeal any *Monument Rule, Regulation* and/or article, section, paragraph and/or sentence in these *Monument Rules and Regulations*.

Catholic Cemeteries further reserve the right to modify and change all prices referred to herein without notice.

## MONUMENT & INSCRIPTION RULES AND REGULATIONS



## **Catholic Cemeteries : Diocese of Rockville Centre**

2. A copy of the current and dated *Monument Rules and Regulations* and current price lists will be available for inspection at Catholic Cemeteries' offices located in each cemetery during regular office hours.

In order to prevent confusion and misunderstanding as to which version of the *Monument Rules and Regulations* is current and is in force, the entire *Monument Rules and Regulations* document shall remain on a Cemetery's premises, shall be available to the Certificate holder, appropriate contractors and vendors, as well as the general public.

3. Special cases may arise in which the literal enforcement of a *rule* may impose unnecessary hardship. The Cemetery Management, therefore, reserves the right to make exceptions, suspensions, or modifications of any of these *Monument Rules and Regulations*, without notice, when in the judgment of the Management, such action appears necessary; such temporary exception, suspension or modification shall in no way be construed as affecting the general applications of such *Monument Rules and Regulations*.

4. If any section, subsection, paragraph, clause provision of these *Monument Rules and Regulations* shall be adjudged invalid, such adjudication shall apply only to the provision so adjudged, and the rest of these *Rules and Regulations* shall remain valid and effective.

5. Due to constant changes in cemetery products, services, governing legislation, as well as general business and ministry practices, the Cemetery has published a complete set of *General Rules and Regulations* under a separate document.

## **MONUMENT & INSCRIPTION RULES AND REGULATIONS**

## Catholic Cemeteries : Diocese of Rockville Centre

### EPITAPHS

As of February 11, 2011  
List of Approved Epitaphs

*Epitaphs selected for a memorial may be restricted due to  
size and design of monument*

*Epitaphs longer than 4 words selected for a bronze memorial  
May be subject to an additional charge per word*

""VOLARE""	"ALL MY LOVE"
"T'WAS GRACE THAT SAVED MY SOUL"	"ALL MY LOVE ALL MY LIFE"
"T'WAS HEAVEN HERE WITH YOU"	"ALL MY LOVE ALWAYS"
"A BEAUTIFUL FOOTPRINT IN THE SANDS OF TIME"	"ALL THINGS HAVE THEIR SEASON"
"A GENTLE HEART, A LOVING SPIRIT"	"ALL THINGS THROUGH CHRIST"
"A GOOD MAN...HE TOUCHED MANY LIVES"	"ALWAYS"
"A HEART AWAY"	"ALWAYS A FAMILY"
"A KISS IN THE WIND IS THE ANSWER TO OUR PRAYERS"	"ALWAYS A SMILE"
"A LEGACY OF STRENGTH"	"ALWAYS AND ALL WAYS"
"A LIFE DEVOTED TO LOVE"	"ALWAYS AND FOREVER IN OUR HEARTS"
"A LITTLE CHILD SHALL LEAD THEM"	"ALWAYS BEAUTIFUL IN OUR EYES"
"A LOVING PERSON"	"ALWAYS FAITHFUL"
"A PART OF YOU WILL ALWAYS BE WITH US"	"ALWAYS FRIENDS"
"A ROSE IN OUR LORD'S HANDS"	"ALWAYS GIVING, ALWAYS CARING"
"A SPARK OF LIFE, A CENTER OF LOVE"	"ALWAYS IN LOVE"
"A THOUGHT IS A PRAYER"	"ALWAYS IN LOVE"
"A TRUE CHRISTIAN COUPLE"	"ALWAYS IN OUR HEART"
"A WOMAN FOR OTHERS"	"ALWAYS IN OUR THOUGHTS"
"ABIDE IN ME, AND I IN YOU"	"ALWAYS LOOK FOR THE GOOD"
"ADORED BY ALL"	"ALWAYS LOVING, ALWAYS CARING, ALWAYS REMEMBERED"
"ALIVE IN CHRIST AND IN OUR HEARTS"	"ALWAYS REMEMBER THE LAUGHTER"
"ALIVE IN OUR HEARTS, UNTIL WE MEET AGAIN"	"ALWAYS REMEMBERED, ALWAYS LOVED"
"ALIVE IN PARADISE"	"ALWAYS WITH US"
"ALL FOR JESUS THROUGH MARY"	"AMAR AL PROJIMO (LOVE THY NEIGHBOR)"
"ALL IS WELL THAT'S DONE BY THEE"	"AMAZING GRACE"
"ALL MANNER OF THINGS SHALL BE WELL"	"AN ANGEL SENT FROM HEAVEN"
	"AN ANGEL TOUCHED HER & THEN SHE SLEPT"
	"AND GOD SHALL WIPE AWAY ALL TEARS"

### MONUMENT & INSCRIPTION RULES AND REGULATIONS

## Catholic Cemeteries : Diocese of Rockville Centre

"AND GOOD IS YOUR NAME"  
"AND I AM WITH YOU ALWAYS"  
"AND I LOVE YOU SO"  
"AND I SHALL DWELL IN THE  
HOUSE OF THE LORD"  
"AND I WILL SEE YOU AGAIN"  
"ANGEL OF GOD"  
"ANGELS WATCHING OVER ME,  
MY LORD"  
"ANOTHER ADVENTURE MAY  
GOD BE WITH YOU"  
"ANYTHING YOU CAN TURN  
YOUR HAND TODO WITH WHAT  
POWER YOU HAV"  
"ARISE MY LOVE"  
"AS EVER AND ALWAYS"  
"AS LOVED AS MY MOTHER WAS  
BEFORE ME"  
"AS WE HAVE LOVED YOU"  
"AS WE HAVE LOVED YOU, WE  
LOVED ONE ANOTHER"  
"ASLEEP IN THE PEACE OF  
CHRIST"  
"AT REST"  
"AVE MARIA"  
"AWAKEN FROM THE DREAM OF  
LIFE"  
"BATHE HER IN YOUR LOVE"  
"BE AT PEACE MY SWEET ANGEL"  
"BE GOOD WITH GODS HELP"  
"BE HAPPY; I'M HAPPY WITH HIM"  
"BE MY LOVE"  
"BE NOT AFRAID"  
"BE NOT AFRAID I GO BEFORE  
YOU ALWAYS"  
"BE NOT AFRAID, ONLY BELIEVE"  
"BE WITH YOU"  
"BEAUTIFUL ROSE OF CLARE"  
"BEAUTY GOODNESS LOVE"  
"BECAUSE OF YOU"  
"BELOVED FRIEND"  
"BELOVED HUSBAND OF..."  
"BELOVED HUSBAND, WIFE"  
"BELOVED IN LIFE, CHERISHED IN  
DEATH"  
"BELOVED MOTHER FOREVER"  
"BELOVED WIFE AND MOTHER"  
"BELOVED, MOURNED &  
UNFORGOTTEN"  
"BELOVED, SLEEP IN PEACE,  
UNTIL I COME TO YE"  
"BETTER LOVED YOU CANNOT  
BE"  
"BLESSED ARE THE  
PEACEMAKERS"  
"BLESSED ARE THE PURE OF  
HEART"  
"BLESSED MOTHER, PRAY FOR  
US"  
"BLESSED MOTHER, THANK YOU"  
"BLESSED VIRGIN PRAY FOR US"  
"BLEST"  
"BLUE EYES"  
"BRAVEST, LOVING PERSON -  
HUSBAND-FATHER-BEST FRIEND"  
"BUTTERFLIES ARE FREE"  
"CALMNESS IS HE ARMOR OF THE  
STRONG"  
"CEAD MILE FAILTE (IRISH-A  
THOUSAND WELCOMES)"  
"CHILDREN OF MARY"  
"COME LORD JESUS"  
"COME SAIL AWAY OUR LOVING  
HUSBAND FATHER SON  
BROTHER"  
"COME TO ME AND REST"  
"COME TO ME, I WILL REFRESH  
YOU"  
"COME, LITTLE LEAVES"  
"CORAZON DE MI VIDA (HEART OF  
MY LIFE)"  
"COURAGE WISDOM & LOVE"  
"COURAGE, LOVE, AND  
ALABASTER"  
"DANCING WITH THE ANGELS"  
"DEAR HEART"  
"DEAR ONE IN HEAVEN"  
"DEAR WIFE, HUSBAND"  
"DEAR, I LOVE YOU"  
"DEAREST BELOVED FOREVER IN  
OUR HEARTS AND IN GOD'S  
GLORY"

## MONUMENT & INSCRIPTION RULES AND REGULATIONS

**Catholic Cemeteries : Diocese of Rockville Centre**

"DEATH IS ONLY A SHADOW ACROSS THE PATH TO HEAVEN"	"FOR ALL ETERNITY"
"DEATH US DID PART - FOR NOW"	"FOR THE LOVE OF"
"DEATH, DID NOT US PART"	"FOR YOUR WORK & PAIN YOU WILL BE REWARDED BY JESUS CHRIST"
"DEUS ET PATRIA"	"FOREVER AND ALWAYS, AMEN"
"DEVOTED PARENTS"	"FOREVER AND EVER"
"DON'T MOURN ME, REMEMBER ME"	"FOREVER IN OUR BLESSED MOTHER'S ARMS"
"EASTER IN HEAVEN"	"FOREVER IN OUR HEARTS"
"EMBRACED BY THE LIGHT"	"FOREVER IN OUR HEARTS - I DO TOO"
"ENDLESS LOVE"	"FOREVER IN YOUR ARMS LOVING YOU"
"ENJOY LIFE"	"FOREVER LOVED"
"ETERNAL IN HIS MERCIFUL LOVE"	"FOREVER MORE"
"ETERNAL LOVE"	"FOREVER ON MY MIND"
"ETERNAL LOVE UNDER GOD"	"FOREVER SMILING IN OUR HEARTS"
"ETERNAL LOVE, ETERNAL MERCY"	"FOREVER YOUNG"
"ETERNAL PEACE"	"FOREVER YOUNG SMILING ANGEL"
"ETERNAL PEACE, NEVER FORGOTTEN"	"FOREVER YOUNG-NOT FADE AWAY"
"ETERNAL REST GRANT UNTO THEM O LORD"	"FOREVER YOUR'S WE'LL REMAIN"
"ETERNALLY IN GOD'S CHOIR"	"FOREVER YOURS"
"ETERNALLY IN OUR HEARTS"	"FOUGHT A GOOD FIGHT"
"EVEN THE SPARROW HAS FOUND A NEST"	"FREE AT LAST"
"EVER WITH THE LORD"	"FRIENDS IN CHRIST"
"EVERLASTING LOVE"	"FROM HEAVEN, A SHOWER OF ROSES"
"EYES TO SEE A HEART TO LOVE"	"FULL OF LIFE"
"FAI LA NINNA, FAI LA NANNA"	"GARDEN OF MEMORIES"
"FAITH, HOPE, LOVE"	"GATES OF HEAVEN ARE NOW OPEN TO ME"
"FAITHFUL & TRUE"	"GENTLEST HEART OUR ETERNAL DREAMER"
"FAMILY FIRST"	"GIVE HER A REWARD OF HER LABORS"
"FAMILY LOVE IS EVERLASTING"	"GOD BE COMPASSIONATE FOR HER/HIM"
"FEEL MY LOVE FOR YOU ALWAYS"	"GOD BE WITH YOU"
"FLEETING STAY, LASTING MEMORY"	"GOD BLESS"
"FOLLOW ME"	"GOD BLESS YOU"
"FOLLOW ME, I WILL BRING YOU LIFE"	"GOD IS GOOD"
"FOLLOW THE WAY OF LOVE"	
"FOND MEMORIES, FOREVER LOVED"	
"FOR A LITTLE WHILE"	

**MONUMENT & INSCRIPTION RULES AND REGULATIONS**

**Catholic Cemeteries : Diocese of Rockville Centre**

"GOD IS LOVE"	"HE WALKS WITH THE LORD"
"GOD IS OUR REFUGE"	"HE WHO LIVES IN LOVE, LIVES IN GOD AND GOD IN HIM"
"GOD IS, LIFE IS, I AM"	"HEART OF JESUS, PRAY FOR US"
"GOD LOVES YOU"	"HEART OF MY HEART"
"GOD MADE THEE MINE"	"HEART OF MY LIFE"
"GOD NEEDED AN ANGEL SO HE CALLED OUR SON"	"HEARTFUL OF LOVE"
"GOD OF HOSTS"	"HEAVEN IS A WHOLE NEW WORLD"
"GOD SHALL WIPE OUT ALL TEARS"	"HEAVEN IS MY HOME"
"GOD THE PROTECTOR"	"HEAVEN'S VERY SPECIAL CHILD"
"GOD'S HOLY WILL"	"HEAVENLY PEACE"
"GOD'S LITTLE ANGEL"	"HER SPIRIT IS FINALLY FREE"
"GOD'S LITTLE ROSE BUD"	"HER UNSELFISH LOVE WAS AN INSPIRATION"
"GOD'S LOVE AND OURS"	"HERE I AM LORD"
"GOD, GRANT ME THE SERENITY"	"HIS HANDS, OUR HEARTS"
"GONE BUT NOT FORGOTTEN"	"HIS LIFE HAS TOUCHED OUR HEARTS"
"GOOD NIGHT, LOVE YOU, SWEET DREAMS"	"HIS LIGHT SHINES ON"
"GOODBYE MY LOVE"	"HIS LOVE MADE US STRONGER"
"GOODNIGHT SWEET PRINCE AND FLIGHTS OF ANGELS SING THEE TO RE"	"HIS MEMORY IS CHERISHED"
"GREET THE DAY WITH A SMILE"	"HIS SON SHALL LEAD US"
"GREET THE DAY WITH A SMILE"	"HOLD MY HAND"
"GRIVE NOT NOR SPEAK OF ME WITH TEARS"	"HOLY MARY PRAY FOR US"
"GUARDIAN ANGEL'S PROTECT US"	"HOLY REST HOLY PEACE"
"HAIL MARY, HOLY MARY"	"HOME WITH THE LORD"
"HAND IN HAND"	"HONEY"
"HAPPY HEARTS FOREVER MORE"	"HONEY, FOREVER IN OUR HEARTS"
"HAPPY TOGETHER FOREVER"	"HOPE IN GOD, HIS LOVE IS EVERLASTING"
"HAPPY WITH JESUS"	"HOW DO I LOVE THEE"
"HARDWORKING HANDS AT REST"	"HOW GOOD IT ALL WAS"
"HE ALONE IS MY ROCK"	"HURT NO ONE HELPED MANY"
"HE CAME HIMSELF TO MEET ME"	"I AM STILL ENCHANTED BY LIGHT YOU BROUGHT TO ME"
"HE HAS FOUGHT BRAVELY"	"I AM THE RESURRECTION"
"HE HELPED US ALL, UNTIL WE MEET AGAIN"	"I AM THE RESURRECTION AND THE LIFE"
"HE IS THE LIGHT"	"I AM THE RESURRECTION AND THE LIGHT"
"HE IS WRITTING SONGS IN HEAVEN"	"I AM WITH YOU ALWAYS"
"HE LOVED EVERYONE HE TOUCHED"	"I BELIEVE IN ANGELS"
"HE RECEIVETH MY SOUL"	"I GO TO PREPARE A PLACE FOR YOU"

**MONUMENT & INSCRIPTION RULES AND REGULATIONS**

## Catholic Cemeteries : Diocese of Rockville Centre

"I HAVE GONE HOME (LORD)"  
"I HAVE KEPT THE FAITH"  
"I LOVE YOU ALWAYS AND FOREVER"  
"I LOVED MY LIFE"  
"I LOVED YOU ALWAYS"  
"I SHALL BUT LOVE THEE BETTER AFTER DEATH"  
"I THANK MY GOD UPON EVERY REMEMBRANCE OF YOU"  
"I WAS SICK AND YOU VISITED ME"  
"I WILL SEE YOU AGAIN"  
"I WILL SING UNTO THE LORD"  
"I'LL BE LOVING YOU ALWAYS"  
"I'LL HOLD YOU IN HEAVEN"  
"I'LL LEND YOU A CHILD HE SAID"  
"I'LL LEND YOU FOR A WHILE HE SAID"  
"IMMACULATE CONCEPTION PRAY FOR US"  
"IN BLESSED PEACE, FOREVER"  
"IN CHRIST, I FOUND ETERNAL LOVE, PEACE & JOY"  
"IN DYING WE FIND ETERNAL LIFE"  
"IN GOD WE TRUST"  
"IN GOD'S CARE"  
"IN GOD'S CARE O GENTLE HEART"  
"IN GOD'S HANDS OVER THE RAINBOW"  
"IN GOD'S LOVING CARE"  
"IN GOD'S LOVING HANDS"  
"IN GOD'S LOVING TENDER CARE"  
"IN HIS HANDS AND IN OUR HEARTS"  
"IN HIS WILL, IS OUR PEACE"  
"IN HOLY MEMORY"  
"IN LIFE GOD GIVES US BUT ONE PARTNER TO DANCE TOGETHER AS ON"  
"IN LOVING MEMORY"  
"IN LOVING MEMORY SWEETHEART"  
"IN MEMORY OF ....."

"IN MY FATHER'S HOUSE"  
"IN OUR HEARTS UNTIL THE RESURRECTION"  
"IN ST. JOHN BOSCO'S CARE"  
"IN THE BEGINNING"  
"IN THE COMPANY OF ANGELS"  
"IN THE CROSS IS HOPE"  
"IN THE GARDEN"  
"IN THE HANDS OF GOD"  
"IN THE PALM OF HIS HAND"  
"IN THE PRESENCE OF THE LORD"  
"IN THE TIME OF NEED, HE WAS THERE"  
"IN TIME OF NEED HE WAS THERE"  
"IN WHOM WE WERE WELL PLEASED"  
"IN YOU WE FOUND GOD"  
"IN YOUR HANDS O LORD"  
"INSEPERABLE"  
"INSTRUMENT OF GOD'S LOVE"  
"IT HAD TO BE YOU, ALWAYS AND FOREVER"  
"IT IS GOOD TO BE WITH THE KING"  
"IT IS IN DYING THAT WE ARE BORN TO ETERNAL LIFE"  
"IT WAS THEN THAT I CARRIED YOU"  
"JE T'AIME (I LOVE YOU)"  
"JESUS AND MARY, WE LOVE YOU - SAVE OUR SOULS"  
"JESUS CRUCIFIED, HAVE MERCY"  
"JESUS HEALS"  
"JESUS I LOVE YOU I'M SORRY THANK YOU I NEED YOU I WANT YOU"  
"JESUS IS CALLING"  
"JESUS IS LORD"  
"JESUS LOVES THE LITTLE CHILDREN"  
"JESUS, HOLD MY HAND"  
"JESUS, MARY, JOSEPH"  
"JOY AND ETERNAL PEACE"  
"JUST SLEEPING"  
"KEEP ON SMILING"

## MONUMENT & INSCRIPTION RULES AND REGULATIONS

## Catholic Cemeteries : Diocese of Rockville Centre

"KEEP THE FAITH"  
"KEEP WITHIN YOUR HEART A  
PLACE FOR DREAMS"  
"KIND, FAITHFUL & WISE"  
"KNOWN AND LOVED BY ALL"  
"LADY OF MT. CARMEL PRAY FOR  
US"  
"LAUGH AND TALK OF ME A  
THOUGH I WERE BESIDE YOU"  
"LEAVE THE DOOR UNLOCKED"  
"LET CHRIST COME INTO YOUR  
HEART"  
"LET HIS SONGS BE HEARD"  
"LET IT BE"  
"LET MY CHILDREN COME TO ME"  
"LET THERE BE PEACE ON EARTH"  
"LET US GO UP TO THE  
MOUNTAIN"  
"LET US LOVE NOT IN WORD - BUT  
IN DEED"  
"LIFE IS A MOMENT, OUR LOVE  
ETERNAL"  
"LIFE IS CHANGED NOT ENDED"  
"LIFE IS CHANGED NOT TAKEN  
AWAY"  
"LIFE IS ETERNAL LOVE  
IMMORTAL"  
"LIFE IS SHORT - LOVE IS  
FOREVER"  
"LIFE WITH JESUS"  
"LIGHT AT THE END OF THE  
TUNNEL"  
"LIGHT OF MY LIFE"  
"LIVE IN MY LOVE"  
"LIVE ON IN MY LOVE"  
"LIVE, LOVE, LAUGH"  
"LONG TO BE REMEMBERED"  
"LONGER THAN ALWAYS"  
"LORD HAVE MERCY ON US"  
"LORD I THANK THEE"  
"LORD INTO YOUR HANDS I GIVE  
UP MY SOUL"  
"LORD JESUS RECEIVE MY SPIRIT"  
"LORD MAKE ME AN INSTRUMENT  
OF THY PEACE"  
"LORD WATCH OVER US"  
"LORD, FOOTPRINTS IN THE  
SAND"  
"LOST AT SEA"  
"LOVE"  
"LOVE ALWAYS FOREVER AND A  
DAY"  
"LOVE ALWAYS WINS"  
"LOVE AND PRAYERS"  
"LOVE CONQUERS ALL"  
"LOVE GOES ON FOREVER"  
"LOVE IS A FOREVER RAINBOW"  
"LOVE IS A GOLDEN GIFT"  
"LOVE IS A WORD-YOU ARE ITS  
MEANING"  
"LOVE IS ALL"  
"LOVE IS FOREVER"  
"LOVE IS FOREVER INTO  
ETERNITY"  
"LOVE IS FOREVER MORE"  
"LOVE IS FOREVER, WE MISS YOU"  
"LOVE IS FROM GOD"  
"LOVE IS GIVING AND  
FORGIVING"  
"LOVE IS KIND"  
"LOVE IS NOT JEALOUS"  
"LOVE IS WHAT WE DO"  
"LOVE IS WITHOUT END"  
"LOVE KNOWS NO BOUNDS"  
"LOVE LASTS FOREVER"  
"LOVE NEVER ASKS IT ANSWERS"  
"LOVE NEVER DIES"  
"LOVE NOW AND FOREVER"  
"LOVE OF MY LIFE"  
"LOVE ONE ANOTHER"  
"LOVE ONE ANOTHER AS I HAVE  
LOVED YOU"  
"LOVE THE MOMENT"  
"LOVE WITHOUT END"  
"LOVE WITHOUT EXCEPTION"  
"LOVE YOU"  
"LOVE, HAPPINESS AND JOY"  
"LOVE, MOM AND DAD"  
"LOVED ALWAYS"  
"LOVED BY ALL"  
"LOVING MOTHER"

## MONUMENT & INSCRIPTION RULES AND REGULATIONS

**Catholic Cemeteries : Diocese of Rockville Centre**

"LOVING MOTHER OF ONE BELOVED GRANDMOTHER OF FOUR"	"MY BELOVED"
"LOVING YOU ALWAYS"	"MY FRIEND, MY LOVE"
"LOVING YOU FOREVER"	"MY HEART WILL GO ON"
"M.T.Y.L.T.T."	"MY HONEY"
"MAKE ME A CHANNEL OF YOUR PEACE"	"MY JESUS HAVE MERCY"
"MAY GOD HOLD YOU IN THE PALM OF HIS HAND"	"MY JESUS MERCY"
"MAY OUR LORD WATCH OVER US"	"MY LIFE, MY LOVE, MY HEART, MY SOUL"
"MAY THE ANGELS LEAD YOU INTO PARADISE"	"MY LIFE, MY LOVE, MY OWN"
"MAY THE ROAD RISE UP TO MEET YOU"	"MY LORD AND MY GOD"
"MAY THE WIND BE ALWAYS AT YOUR BACK"	"MY LOVE, YOU'RE ONE IN A MILLION"
"MAY YOUR ANGEL GUIDE YOU"	"MY PEACE I GIVE YOU"
"MAY YOUR LIGHT SHINE UPON US"	"MY SHINING STAR"
"MELODY LINGERS"	"MY SOUL DOTHS SLEEP WITH THE LORD"
"MEMORIES - A KEEPSAKE OF THE HEART"	"MY SOUL MAGNIFIES THE LORD"
"MEMORIES ARE FOREVER"	"MY SOUL PROCLAIMS THE GREATNESS OF THE LORD"
"MEMORIES NEVER DIE"	"MY WEE SWEETHEART"
"MERCIFUL MOTHER"	"NEE"
"MINE EYES HAVE SEEN THE GLORY"	"NEVER FORGOTTEN"
"MIRACLE OF LIFE"	"NEVER NEVER, WILL YOU LEAVE US"
"MISSED-NEVER FORGOTTEN"	"NEVER SAY GOODBYE"
"MISSING YOU DEEPLY"	"NEVER STOP LOVING YOU"
"MIZPAH"	"NEW LIFE IN CHRIST"
"MORE THAN THE GREATEST LOVE"	"NO GREATER LOVE"
"MORE THAN THE GREATEST LOVE I'VE EVER KNOWN"	"NO WORDS LEFT UNSPOKEN"
"MOST EXCEPTIONAL WIFE AND MOTHER"	"NONE ON EARTH CAN TAKE YOUR PLACE"
"MOST PRECIOUS BLOOD"	"NOW COMETH REST"
"MOST SACRED HEART"	"NOW HEAVEN'S GATES ARE OPEN TO YOU"
"MOTHER DEAREST, MOTHER FAIREST"	"NOW ONE WITH CHRIST'S LIGHT"
"MOTHER OF GOD, PRAY FOR US"	"O KIND AND GENTLEST HEART"
"MOTHER TO ALL"	"O LORD O GOD"
"MUCH HAVE I/WE LOVED YOU"	"OH GENTLEST HEART"
	"ON EAGLES WINGS"
	"ONE DAY AT A TIME"
	"ONE EACH OTHER"
	"ONE LIFE, ONE LOVE"
	"ONE MOMENT IN TIME"
	"ONLY A WHILE AND THEN ETERNITY"
	"ONLY GOD CONQUERS"

**MONUMENT & INSCRIPTION RULES AND REGULATIONS**



**Catholic Cemeteries : Diocese of Rockville Centre**

"ONWARD AND COURAGE"	"PEACE AND QUIET"
"OUR BELOVED ANGEL"	"PEACE AT LAST"
"OUR BELOVED CHILDREN"	"PEACE BE WITH YOU"
"OUR BELOVED, OVER THE RAINBOW"	"PEACE PERFECT PEACE"
"OUR BELOVED-SAFE IN GOD'S KEEPING"	"PEACE WITH GOD"
"OUR BLESSED ANGEL"	"PEACEFULLY RESTING"
"OUR BOND IS EVERLASTING"	"PERFECT LOVE"
"OUR DEAREST TREASURE"	"PLEASE BE HAPPY"
"OUR FAMILY IS A CIRCLE OF STRENGTH"	"PRAISE THE LORD"
"OUR GUARDIAN ANGEL"	"PRAY FOR US"
"OUR LADY OF PERPETUAL HELP PRAY FOR US"	"PRAY WITH ME"
"OUR LADY OF SORROWS PRAY FOR US"	"PRAYER IS A SONG OF THE HEART"
"OUR LIFE, OUR LOVE, OUR EVERYTHING"	"PRECIOUS ARE OUR MEMORIES OF YOU"
"OUR LITTLE ANGEL"	"PRECIOUS BLOOD"
"OUR LOVE ALWAYS WITH YOU"	"PRECIOUS MOMENTS"
"OUR LOVE AND HEARTS ARE ALWAYS WITH YOU"	"PREDICTABLY UNPREDICTABLE"
"OUR LOVE AND LAUGHTER"	"QUEEN OF PEACE PRAY FOR US"
"OUR LOVE GOES WITH YOU"	"QUIET, DIGNITY"
"OUR LOVE IS FOREVER"	"RAISED TO LIFE WITH CHRIST"
"OUR LOVE IS THE GIFT OF OUR LIFE"	"RARE, PRECIOUS, BEAUTIFUL"
"OUR LOVE WILL LIGHT THE WAY"	"REDEEMED FROM EARTH'S DARK NIGHT"
"OUR LOVE WILL NEVER DIE"	"REMEMBER A BEAUTIFUL LIFE"
"OUR LOVE WITH YOU FOREVER"	"REMEMBER ME AS LOVING YOU"
"OUR MIRACLE BABY"	"REMEMBER ME AT THE ALTAR OF THE LORD"
"OUR OWN LITTLE ANGEL"	"REMEMBER ME LAUGHING & LOVING YOU"
"OUR PRECIOUS JEWEL"	"REMEMBER MY LOVE FOR YOU"
"OUR PRECIOUS LOVE"	"REMEMBERED ALWAYS WITH JOY"
"OUR SHINING STAR"	"REMEMBERENCE OF YOU BRINGS JOY"
"OUR SHINING STAR IN THE SKY"	"REMEMBERING YOU IS LOVING YOU"
"OUR SON LIVES FOREVER"	"REQUIESCANT IN PACE"
"OUR SPECIAL ANGEL"	"REQUIESCE IN AMOR NOSTRO (REST IN OUR LOVE)"
"OUR TEARS WILL TURN INTO DANCING"	"RESPECT LIFE"
"OUR THOUGHTS ARE OF YOU"	"REST IN GOD'S CARE"
"OURS FOR A LITTLE WHILE WITH JESUS FOREVER"	"REST IN OUR LOVE"
"PEACE"	"REST IN PEACE"
	"REST IN PEACE - PRAY FOR US"
	"REST IN PEACE IN HEAVEN"

**MONUMENT & INSCRIPTION RULES AND REGULATIONS**

## Catholic Cemeteries : Diocese of Rockville Centre

"REST IN PEACE MY LOVE"  
"REST IN THE ARMS OF JESUS"  
"RESTING IN OUR LORD'S HANDS"  
"RETURNED TO THE EARTH WE LOVE"  
"RETURNING TO MY FAHTER"  
"RIPOSA IN PACE"  
"SACRED HEART"  
"SACRED HEART HAVE MERCY"  
"SACRED HEART OF JESUS GRANT US YOUR SALVATION"  
"SACRED HEART OF JESUS IN THEE WE TRUST"  
"SACRED HEART OF JESUS PRAY FOR US"  
"SADLY MISSED"  
"SAFE IN THE ARMS OF JESUS"  
"SAFE WITH THE ANGELS"  
"SAFELY HOME"  
"SAFELY HOME SINGING THE LORDS PRAYER"  
"SAINTLY WIFE & MOTHER"  
"SALUDADES DE ESPOSA E FILHAS-GREETINGS FROM WIFE AND DGHTR"  
"SAN LUIGI GONZAGA PRAY FOR US"  
"SAY AN AVE HERE FOR ME"  
"SAY IT FROM THE HEART"  
"SAY ONE HAIL MARY"  
"SAY THE MEMORARE"  
"SEE YOU IN MY DREAMS"  
"SEMPER FIDELIS"  
"SENT UP TO THE MOUNTAIN"  
"SERENITY, COURAGE AND WISDOM"  
"SERENITY, COURAGE, WISDOM, LOVE-YOU ARE WITH ME IN PARADISE"  
"SHE LOVED ALL"  
"SHE PRAYETH BEST WHO LIVETH BEST"  
"SHE SHALL HAVE MUSIC WHEREVER SHE GOES"  
"SHELTER US O LORD"  
"SIDE BY SIDE IN LIFE, WITH HOPE IN DEATH BEFORE GOD"  
"SIMPLE MAN GONE BUT NOT FORGOTTEN"  
"SIMPLY THE BEST"  
"SLEEP IN HEAVENLY PEACE"  
"SLEEP WELL MY LOVE"  
"SLEEP WITH THE ANGELS"  
"SOLO TESEMPRA OH MY LORD"  
"SOMEONE TO WATCH OVER ME"  
"SON EPOUX (HER HUSBAND)"  
"SORROW IS NOT FOREVER - LOVE IS"  
"SOUL DOTH SLEEP WITH THE LORD (MY-HER-HIS)"  
"SOULMATES FOREVER"  
"SPECIAL"  
"ST. ANNE PRAY FOR US"  
"ST. ANTHONY PRAY FOR US"  
"ST. FRANCIS PRAY FOR US"  
"ST. JOSEPH PRAY FOR US"  
"ST. JUDE PRAY FOR US"  
"ST. PETER PRAY FOR US"  
"STILL HOLDING HANDS"  
"STILL THE LOVE OF MY LIFE"  
"STILL TOGETHER"  
"STRENGTH & KINDNESS"  
"SWEET JESUS HAVE MERCY ON HIS OR HER SOUL"  
"SWEETHEARTS FOREVER"  
"TAKEN TOO SOON"  
"TEACH US AND GUIDE US"  
"TEACH US AND GUIDE US"  
"TERM OF ENDEARMENT"  
"THANKS FOR THE MEMORIES"  
"THE BEGINNING"  
"THE BEST IS YET TO BE"  
"THE GREATEST LOVE OF ALL"  
"THE HEART HAS ITS OWN MEMORY"  
"THE LORD BLESS YOU AND KEEP YOU"  
"THE LORD IS KIND AND MERCIFUL"  
"THE LORD IS MY LIGHT"  
"THE LORD IS MY SHEPHERD"

## MONUMENT & INSCRIPTION RULES AND REGULATIONS

**Catholic Cemeteries : Diocese of Rockville Centre**

"THE LORD IS WITH THEE"	"TO GOD ON WINGS OF SONG"
"THE LORD LIGHTS THE WAY"	"TO JESUS THROUGH MARY"
"THE LORD WATCH BETWEEN ME AND THEE"	"TO KNOW HER IS TO LOVE HER"
"THE LOVE LIVES ON"	"TO MY LOVE ALWAYS"
"THE PEACE OF SAINT FRANCIS BE WITH YOU"	"TO SEE AND LOVE IN CHRIST"
"THE ROSE BEYOND THE WALL"	"TO THE WORLD YOU WERE JUST SOMEONE TO US YOU WERE THE WORLD"
"THE STRIFE IS O'ER, THE BATTLE DONE"	"TO THE WORLD YOU WERE JUST SOMEONE, TO US YOU WERE THE WORLD"
"THE SUNSHINE OF OUR LIVES"	"TODAY, TOMORROW & ALWAYS"
"THE SWEETEST THING"	"TOGETHER AGAIN"
"THE WIND BENEATH MY WINGS"	"TOGETHER FOREVER"
"THEN, NOW & FOREVER"	"TOGETHER FOREVER, AS IT WAS AND AS IT SHALL ALWAYS BE"
"THERE IS JOY IN HEAVEN"	"TOGETHER IN GOD'S CARE"
"THERE'S A PLACE FOR US...SOMEWHERE"	"TOGETHER IN THE LIGHT"
"THEY SHALL MOUNT UP WITH WINGS LIKE EAGLES"	"TREASURE THE MEMORIES"
"THEY WALK WITH GOD"	"TRUE FRIEND WILL CHERISH YOU FOREVER"
"THINGS WILL NEVER BE THE SAME"	"TRUE LOVE NEVER DIES"
"THOU SHALT BE WITH ME IN PARADISE"	"TRUE LOVE NEVER SAYS GOODBYE"
"THOU SHALT BE WITH ME IN PARADISE"	"UNFORGETTABLE"
"THREE TIMES A LADY"	"UNO RED ROSE FOR OUR LOVE"
"THROUGH THE YEARS OUR SWEETEST DAYS WE FOUND WITH YOU"	"UNTIL"
"THY ETERNAL SUMMER SHALL NOT FADE"	"UNTIL CHRIST'S RETURN"
"THY KINGDOM COME"	"UNTIL WE MEET AGAIN"
"THY SPIRIT DOTHSOAR"	"UNTO THY HANDS O LORD"
"THY WILL BE DONE"	"UP IN HEAVEN"
"TILL THE TWELFTH OF NEVER"	"VERGINE DEL PORTERE, PREGA PER NOI"
"TILL THEE AND WE MEET AGAIN"	"VIRGIN OF STRENGTH PRAY FOR US"
"TILL WE'RE TOGETHER AGAIN"	"VOLARE - ON EAGLES WINGS"
"TIME GOES BY"	"WALK HAND IN HAND WITH ME"
"TIME OF MY LIFE"	"WALK ON THE STREETS OF GOLD"
"TIS THE LAST OF EARTH, I AM CONTENT"	"WALK SOFTLY AN ANGEL LIES HERE"
"TO EVERLASTING BLISS IN HEAVEN"	"WALKING ON THE BEACH WITH GOD"
"TO EVERYTHING THERE IS A SEASON"	"WATCH OVER US"
	"WE ARE THE LIGHT OF THE WORLD"

**MONUMENT & INSCRIPTION RULES AND REGULATIONS**

**Catholic Cemeteries : Diocese of Rockville Centre**

"WE BUILT BRIDGES TO LOVE"	"WITH PRIDE ON EAGLE'S WINGS"
"WE LIVE IN HEARTS WE LEAVE"	"WITH THE HELP OF GOD"
"WE LOVE AND MISS YOU-WE ALWAYS WILL"	"WITH YOU ALWAYS"
"WE LOVE YOU"	"WITH YOU I AM BORN AGAIN"
"WE LOVE YOU ALWAYS AND FOREVER"	"WRAPPED IN JESUS BLANKET"
"WE LOVE YOU SWEETHEART"	"YES LORD I BELIEVE"
"WE LOVE YOU VERY MUCH"	"YOU ARE BREATH, SMILES, TEARS AND ALL MY LIFE"
"WE NEVER LOSE THOSE WE GIVE TO GOD"	"YOU ARE HOME, TAKE MY HAND"
"WE SHARE HER PEACE"	"YOU ARE LOVE"
"WE WILL ALWAYS REMEMBER YOU"	"YOU ARE MINE"
"WE WILL BE TOGETHER ALWAYS"	"YOU ARE WITH ME IN PARADISE"
"WE WILL HOLD YOU IN OUR HEARTS FOREVER"	"YOU BROUGHT HEAVEN TO EARTH"
"WE WILL NEVER FORGET YOU"	"YOU GAVE ME WINGS AND MADE ME FLY"
"WE WILL NEVER LET YOU GO"	"YOU HAVE GIVEN, MORE YOU RECEIVE (TRANS FROM LATIN)"
"WE'LL KISS YOU IN OUR DREAMS"	"YOU LEAVE US WITH LOVE AND LAUGHTER"
"WE'LL MEET AGAIN SOME SUNNY DAY"	"YOU LIGHT UP MY LIFE"
"WEEP NOT, FOR I GO TO THE FATHER"	"YOU LIVE IN OUR MEMORY"
"WELL DONE THOU GOOD & FAITHFUL SERVANT"	"YOU TOUCHED SO MANY"
"WHAT IS LOVES REMAINS IN THE HEART"	"YOU WERE THE LIGHT OF OUR WORLD"
"WHERE THERE IS LOVE THERE IS NO DEATH"	"YOU WILL ALWAYS BE WITH US"
"WHEREVER YOU GO"	"YOU'RE MY EVERYTHING"
"WHO BELIEVES IN ME WILL LIVE"	"YOUR HEART AND STRENGTH INSPIRE US ALWAYS"
"WIFE AND MOTHER"	"YOUR LOVE IS DEEP IN OUR HEARTS"
"WIFE-MOTHER-FRIEND"	"YOUR MELODY LINGERS ON"
"WIFE-MOTHER-SPECIAL LADY"	"YOUR MEMORY IS OUR LIGHT"
"WITH A SONG IN HIS HEART"	"YOUR PEARLS OF WISDOM WILL SUSTAIN US"
"WITH GOD"	"YOUR SMILE IS IN OUR HEARTS"
"WITH JESUS ALWAYS"	"YOURS ALWAYS"
"WITH LOVE"	"ZA PRACE I BOL WYNAGRODZI CHRYSTUS KROL (POLISH,WORK,PAIN)"
"WITH OUR LOVE"	"ZBOGEM (POLISH - GOD BE WITH YOU)"

**MONUMENT & INSCRIPTION RULES AND REGULATIONS**

**Catholic Cemeteries : Diocese of Rockville Centre**

*Saint Brigid's Section Codes  
as described in the Holy Rood Cemetery  
Interment Directory.*

<i>AGN ST. AGNES</i>	<i>EDM ST. EDMUND</i>
<i>AGS ST. AGNES SO.</i>	<i>ELI ST. ELIZABETH</i>
<i>ALP ST. ALPHONSUS</i>	<i>ELS ST. ELIZABETH SO.</i>
<i>ANN ST. ANNE</i>	<i>FER ST. FERDINAND</i>
<i>ANS ST. ANNE SO.</i>	<i>FRA ST. FRANCIS ASSISI</i>
<i>ANT ST. ANTHONY</i>	<i>FRS ST. FRANCIS ASSISI SO.</i>
<i>CAS ST. CATHERINE SO</i>	<i>GAL ST. GALL</i>
<i>CAT ST. CATHERINE</i>	<i>HER ST. HERBERT</i>
<i>CEC ST. CECILIA</i>	<i>IGN ST. IGNATIUS</i>
<i>CES ST. CECILIA SO</i>	<i>JAM ST. JAMES APOSTLE</i>
<i>DAN ST. DANIEL</i>	<i>JAS ST. JAMES APOSTLE SO.</i>

**MONUMENT & INSCRIPTION RULES AND REGULATIONS**

**Catholic Cemeteries : Diocese of Rockville Centre**

<i>JER ST.JEROME</i>
<i>JOB ST. JOHN THE BAPTIST</i>
<i>JOH ST. JOHN THE APOSTLE</i>
<i>JOS ST.JOHN THE APOSTLE SO.</i>
<i>JUL ST. JULIANA SO.</i>
<i>KIL ST. KILIAN</i>
<i>LAW ST. LAWRENCE</i>
<i>LEO ST. LEONARD</i>
<i>LIT LITTLE FLOWER</i>
<i>LUC ST.LUCY</i>
<i>LUS ST. LUCY SO.</i>
<i>MAR ST. MARTHA</i>
<i>MAS ST. MARTHA SO.</i>

<i>MGS ST. MARGARET SO.</i>
<i>MGT ST. MARGARET</i>
<i>MIC ST. MICHAEL</i>
<i>NAT ST. NATHANIEL</i>
<i>NIC ST. NICHOLAS</i>
<i>NOR ST.NORBERT</i>
<i>NOS ST. NORBERT SO.</i>
<i>OSW ST. OSWALD</i>
<i>OWE ST. OWEN</i>

**MONUMENT & INSCRIPTION RULES AND REGULATIONS**

Catholic Cemeteries : Diocese of Rockville Centre

<i>OWS ST. OWEN SO.</i>	<i>PHS ST. PHILIP SO.</i>
<i>PAS ST. PATRICK SO.</i>	<i>PLS ST. PAUL THE APOSTLE</i>
<i>PAT ST. PATRICK</i>	<i>PRI ST. PRISCILLA</i>
<i>PAU ST. PAUL THE APOSTLE</i>	<i>QUE ST. QUENTIN</i>
<i>PEA ST. PETER THE APOSTLE</i>	<i>RAY ST. RAYMOND</i>
<i>PES ST. PETER SO.</i>	<i>RBS ST. ROBERT SO.</i>
<i>PET ST. PETER</i>	<i>RIC ST. RICHARD</i>
<i>PHI ST. PHILIP</i>	<i>ROB ST. ROBERT</i>

MONUMENT & INSCRIPTION RULES AND REGULATIONS

Catholic Cemeteries : Diocese of Rockville Centre

<i>ROE ST. ROSE</i>	<i>VIS ST. VINCENT DE PAUL SO.</i>
<i>ROS ST. ROSE SO.</i>	<i>WEN ST. WENCESLAUS</i>
<i>STE ST. STEPHEN</i>	<i>WIL ST. WILLIAM</i>
<i>TER ST. TERRENCE</i>	<i>XAV ST. XAVIER</i>
<i>THO ST. THOMAS</i>	<i>YVO ST. YVONNE</i>
<i>UBA ST. UBALD</i>	<i>ZAC ST. ZACHARY</i>
<i>VER ST. VERONICA</i>	
<i>VIN ST. VINCENT DE PAUL</i>	

MONUMENT & INSCRIPTION RULES AND REGULATIONS



**Catholic Cemeteries : Diocese of Rockville Centre**

**Sample Monument/Inscription/Removal/Amendment and/or Permit  
“Authorizing to Commence Order for Work” form**

<p><b>CATHOLIC CEMETERIES</b> DIOCESE OF ROCKVILLE CENTRE <i>Main Office</i> HOLY ROOD CEMETERY, OLD COUNTRY RD. P.O. BOX 182 WESTBURY, N.Y. 11590</p>	<p><b>CEMETERY OF THE HOLY ROOD</b> OLD COUNTRY ROAD P.O. BOX 182 WESTBURY, NEW YORK 11590 PHONE # 516-334-7990</p>		
<p><b>APPLICATION FOR STONEMWORK OR INSCRIPTION APPROVAL</b></p>			
<p align="right">Date _____</p>			
<p>Ordered by _____</p>			
<p>Address _____</p>			
<p>Name on Certificate _____</p>			
<p>Section _____ Range _____ Plot _____ No. _____</p>			
<p>Contractor _____</p>			
<p>Address _____ Valuation _____</p>			
<p>Type of Granite _____ Foundation Size _____ x _____</p>			
<p>Remarks _____</p>			
<table border="0" style="width: 100%;"> <tr> <td style="width: 60%; vertical-align: top;"> <p><i>OFFICE USE:</i></p> <p><input type="checkbox"/> Inscription Fee: Paid _____</p> <p><input type="checkbox"/> Foundation: Paid _____ Date _____ Rec. # _____</p> <p>Certificate Presented at Office, Date _____</p> <p>Foundation Completed, Date _____</p> </td> <td style="width: 40%; vertical-align: top; border: 1px solid black; padding: 5px;"> <p align="center"><b>APPROVED AS CHECKED</b></p> <p>Date _____</p> <p>By _____</p> </td> </tr> </table>		<p><i>OFFICE USE:</i></p> <p><input type="checkbox"/> Inscription Fee: Paid _____</p> <p><input type="checkbox"/> Foundation: Paid _____ Date _____ Rec. # _____</p> <p>Certificate Presented at Office, Date _____</p> <p>Foundation Completed, Date _____</p>	<p align="center"><b>APPROVED AS CHECKED</b></p> <p>Date _____</p> <p>By _____</p>
<p><i>OFFICE USE:</i></p> <p><input type="checkbox"/> Inscription Fee: Paid _____</p> <p><input type="checkbox"/> Foundation: Paid _____ Date _____ Rec. # _____</p> <p>Certificate Presented at Office, Date _____</p> <p>Foundation Completed, Date _____</p>	<p align="center"><b>APPROVED AS CHECKED</b></p> <p>Date _____</p> <p>By _____</p>		
<p>Every monument contractor must acquaint himself with complete stonework regulations for <b>Cemetery of the Holy Rood</b> which can be procured by contacting the cemetery office.</p> <p>Foundation or inscription fee in full must accompany application.</p> <p>Original Certificate of Right of Burial is accepted as authorization for monument work, and will be returned to the dealer with approved application. It is the responsibility of the monument dealer to return the Certificate to the customer as soon as possible. It is not to be held in lieu of payment.</p> <p>All monument setters and sandblasters must have an approved insurance certificate on file with the cemetery office. Contractor is responsible for damage caused to any plot, planting or monument. It is the right of the cemetery authorities to deny permission to enter the premises to any contractor not complying with regulations or instructions of cemetery authorities.</p> <p>The principal symbol of each monument is the cross, and this symbol must not be hidden or dwarfed by any other symbol or decorative feature. Please consult regulations for permitted symbols.</p> <p align="center"><b>PLEASE SHOW SKETCH ON REAR OF APPLICATION. SKETCH MUST BE TO SCALE SHOWING ALL SIZES AND DIMENSIONS, AND DETAIL OF INSCRIPTIONS AND ORNAMENTATION.</b></p>			

**MONUMENT & INSCRIPTION RULES AND REGULATIONS**

SAMPLE FOUNDATION READY FOR INSTALLATION FORM

***CEMETERY OF THE HOLY ROOD***

**Phone: 516-334-7990**

**Fax: 516-333-2837**

**111 Old Country Road**

**P.O. Box 182**

**Westbury N.Y. 11590**

Date: \_\_\_\_\_

\_\_\_\_\_

\_\_\_\_\_

\_\_\_\_\_

Foundation for \_\_\_\_\_

Sec. \_\_\_\_\_, Range \_\_\_\_\_, No. \_\_\_\_\_

is now completed.

**NO SETTING WITHOUT THIS PERMIT**

**ALL STONWORK MUST BE INSPECTED BEFORE SETTING**

**No inscription work or monument setting shall take place from Holy Thursday up to and including Easter Sunday, nor from the Thursdays immediately preceding Mother's Day and Father's Day, nor the day prior to Christmas Day and New Year's Day.**

Catholic Cemeteries : Diocese of Rockville Centre

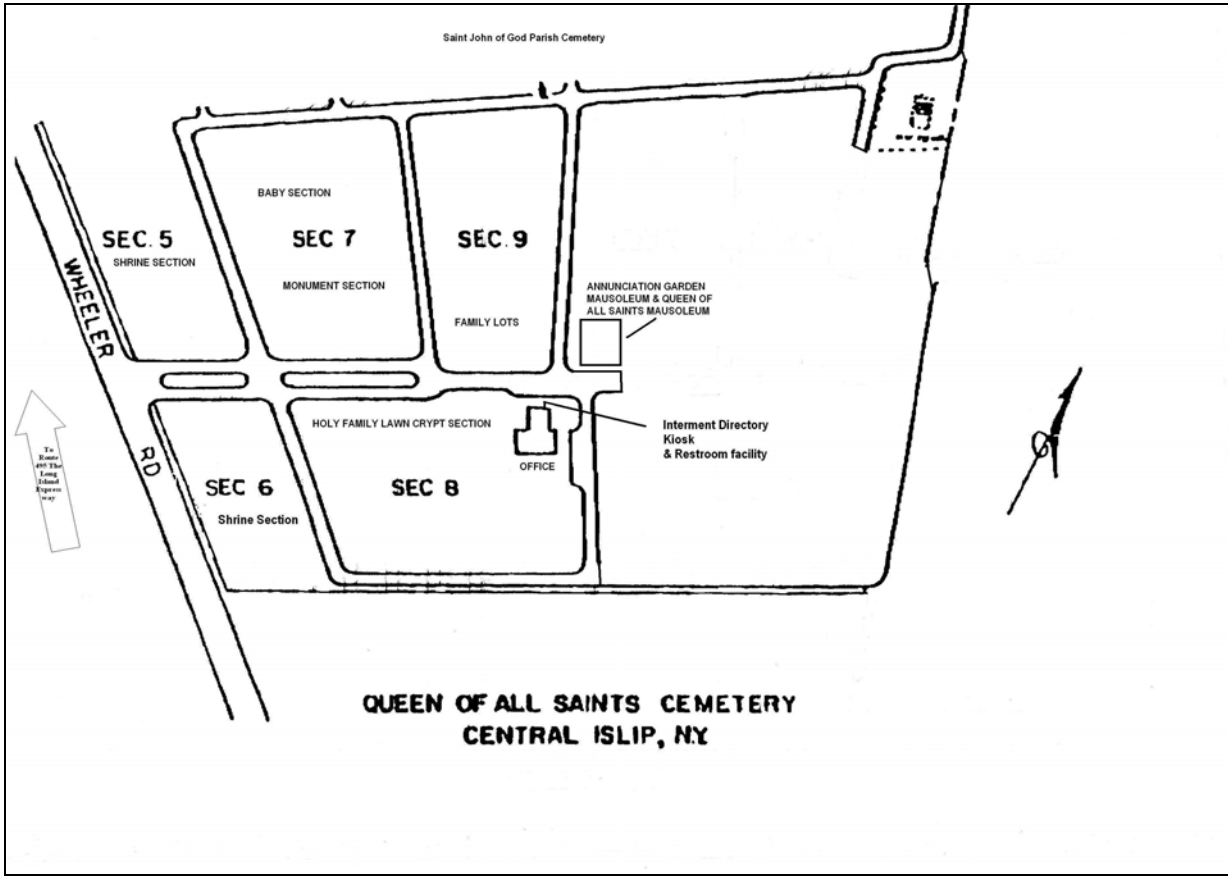

MONUMENT & INSCRIPTION RULES AND REGULATIONS

**Catholic Cemeteries : Diocese of Rockville Centre**

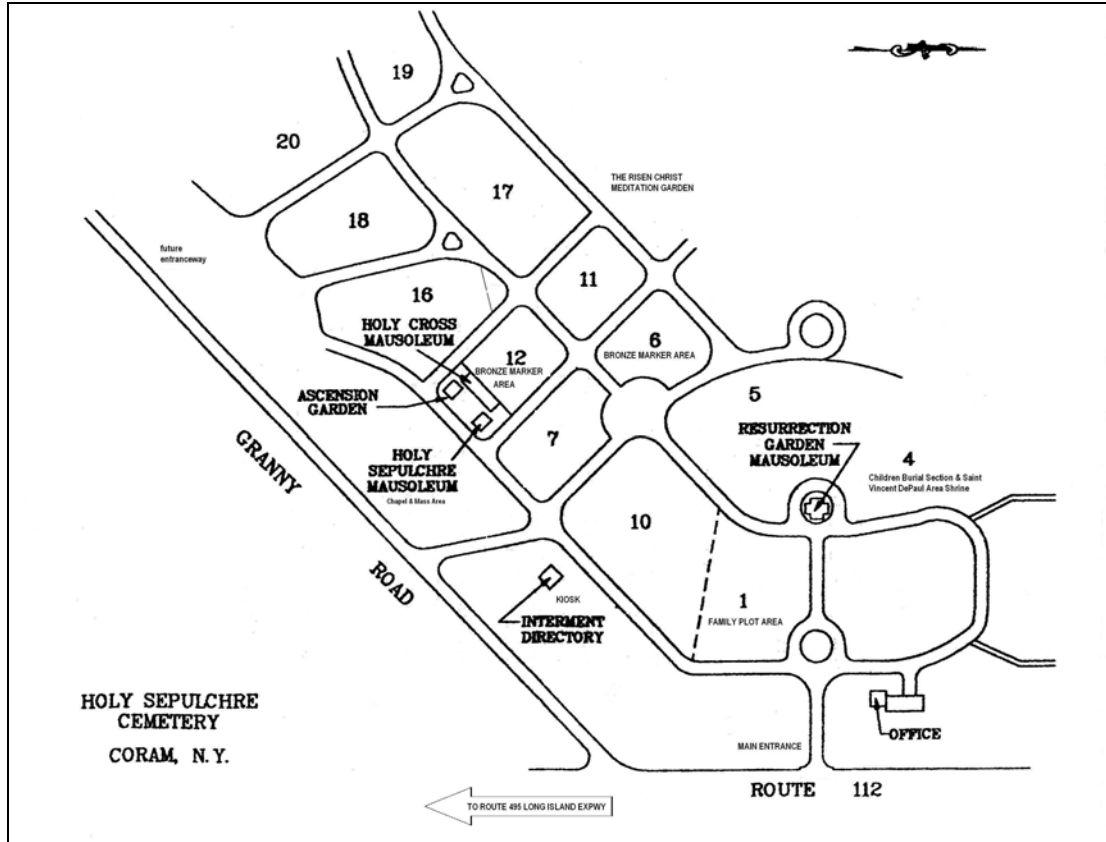

**MONUMENT & INSCRIPTION RULES AND REGULATIONS**

Catholic Cemeteries : Diocese of Rockville Centre

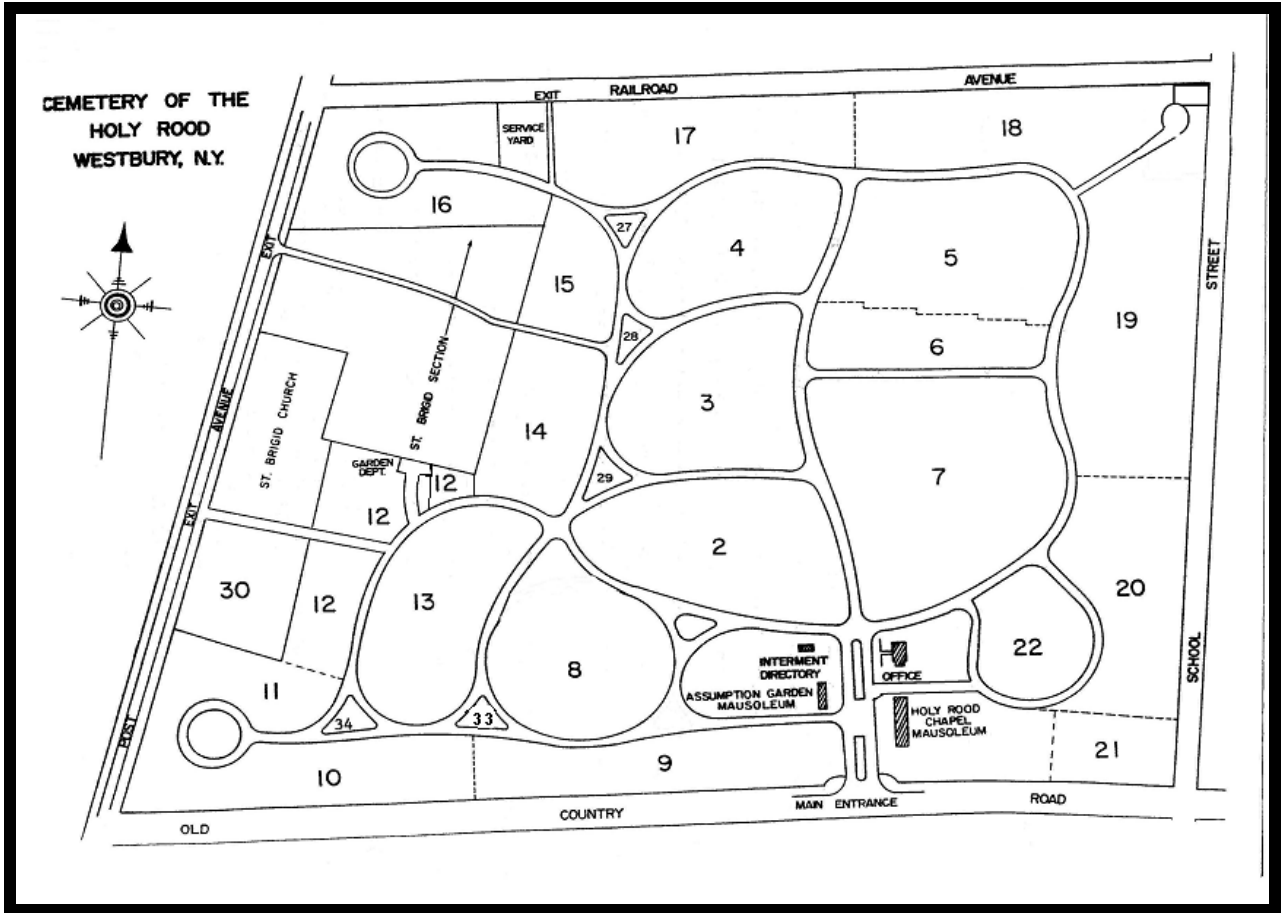

MONUMENT & INSCRIPTION RULES AND REGULATIONS

# Catholic Cemeteries : Diocese of Rockville Centre

*Saint*  
*Brigid's*  
*Parish*  
*Cemetery*

Range : \_\_\_\_\_

Lot Number : \_\_\_\_\_

**Saint Brigid's Section Codes as described in the Holy Road Cemetery Interment Directory**

AGA ST AGNES	AGL ST AGNES NO.	ALP ST ALFONSO	AMA ST ANNE	AMS ST ANNE NO.	ANT ST ANTHONY	CAN ST CANNEDINI NO.	CAT ST CATERINE	CEC ST CECILIA	CEI ST CECILIA NO.	DMR ST DANIEL	EDM ST EDMUND	FER ST FERDINAND	GAL ST GALL	HER ST HERBERT	IGN ST IGNATIUS	JAC ST JAMES	JER ST JEROME	KIL ST KILLIAN	LEO ST LEONARD	MIC ST MICHAEL	NAT ST NATHANIEL	PAT ST PATRICK	RAY ST RAYMOND	ROSE ST ROSE	STP ST STEPHEN	TER ST TERRENCE	UBA ST UBALD	VER ST VERONICA	WEN ST WENCESLAUS	XAV ST XAVIER	YVO ST YVONNE	ZAC ST ZACHARY	THO ST THOMAS	ALP ST ALPHONSUS	RIC ST RICHARD	ANT ST ANTHONY	JBA ST JOHN BAPTIST	LAW ST LAWRENCE	NIC ST NICHOLAS	PET ST PETER	WIL ST WILLIAM
EDM ST EDMUND	FER ST FERDINAND	GAL ST GALL	HER ST HERBERT	IGN ST IGNATIUS	JAC ST JAMES	JER ST JEROME	KIL ST KILLIAN	LEO ST LEONARD	MIC ST MICHAEL	NAT ST NATHANIEL	PAT ST PATRICK	RAY ST RAYMOND	ROSE ST ROSE	STP ST STEPHEN	TER ST TERRENCE	UBA ST UBALD	VER ST VERONICA	WEN ST WENCESLAUS	XAV ST XAVIER	YVO ST YVONNE	ZAC ST ZACHARY	THO ST THOMAS	ALP ST ALPHONSUS	RIC ST RICHARD	ANT ST ANTHONY	JBA ST JOHN BAPTIST	LAW ST LAWRENCE	NIC ST NICHOLAS	PET ST PETER	WIL ST WILLIAM											

## MONUMENT & INSCRIPTION RULES AND REGULATIONS

## **Catholic Cemeteries : Diocese of Rockville Centre**

### **Prayers for that Special Time**

Your visit to the cemetery is a very special and personal time. It can be difficult to know what to say or what to do, especially the first time you come to visit. We hope the following prayers will be of help.

## **Traditional Catholic Prayers**

### **Sign of the Cross**

In the Name of the Father,  
and of the Son,  
and of the Holy Spirit.  
Amen.

### **Glory Be**

Glory be to the Father,  
and to the Son,  
and to the Holy Spirit.  
As it was in the beginning, is now and ever shall be, world without  
end.  
Amen.

### **Psalm 23**

The Lord is my shepherd,  
I shall not want.  
He makes me lie down in green pastures;  
he leads me beside still waters;  
he restores my soul.  
He leads me in right paths  
for his name's sake.  
Even though I walk through the darkest valley,  
I fear no evil;  
for you are with me; your rod and your staff;  
they comfort me.  
You prepare a table before me  
in the presence of my enemies;  
you anoint my head with oil;  
my cup overflows.  
Surely goodness and mercy shall follow me  
all the days of my life,  
and I shall dwell in the house of the Lord  
my whole life long.

## **MONUMENT & INSCRIPTION RULES AND REGULATIONS**

## **Catholic Cemeteries : Diocese of Rockville Centre**

### **For The Dead**

Eternal rest grant to them, O Lord,  
and let perpetual light shine upon them.  
May their souls, and the souls of all the faithful departed,  
through the mercy of God, rest in peace.  
Amen.

### **Hail Mary**

Hail Mary, full of grace,  
the Lord is with you.  
Blessed are you among women,  
and blessed is the fruit of your womb, Jesus.  
Holy Mary, Mother of God,  
Pray for us sinners now,  
and at the hour of our death.  
Amen.

### **The Lord's Prayer**

Our Father,  
Who art in heaven,  
hallowed be thy name.  
Thy kingdom come.  
Thy will be done on earth as it is in heaven.  
Give us this day our daily bread,  
and forgive us our trespasses  
as we forgive those who trespass against us.  
And lead us not into temptation  
but deliver us from evil.  
Amen.

### **PRAYER SERVICE AT THE CEMETERY**

(adapted from the Book of Blessings)

Praise be to God our Father,  
who raised Jesus Christ from the dead.  
Blessed be God for ever.  
We gather today to pray for (Name) whose body lies here in rest.  
(Name) has passed from death to life in company with the Lord  
Jesus, who died and rose to new life, and is purified now of all  
faults. We pray that God may welcome (Name) among all the  
saints of heaven.  
Amen.

### **A reading from the first letter of Paul to the Thessalonians: 4:13-18**

We do not want you to be unaware, brothers and sisters, about  
those who have fallen asleep, so that you may not grieve like the  
rest, who have no hope. For if we believe that Jesus died and rose,  
so too will God, through Jesus, bring with him those who have

## **MONUMENT & INSCRIPTION RULES AND REGULATIONS**



## Catholic Cemeteries : Diocese of Rockville Centre

fallen asleep. Indeed, we tell you this, on the word of the Lord, that we who are alive, who are left until the coming of the Lord, will surely not precede those who have fallen asleep. For the Lord himself, with a word of command, with the voice of an archangel and the trumpet of God, will come down from heaven, and the dead in Christ will rise first. Then we who are alive, who are left, will be caught up together with them in the clouds to meet the Lord in the air. Thus we shall always be with the Lord. Therefore, console one another with these words.

### **Psalm 25**

To you, O Lord, I lift up my soul.  
In you I trust; let me not be put to shame, let not my enemies exult over me. No one who waits for you shall be put to shame; those shall be put to shame who heedlessly break faith.  
To you, O Lord, I lift up my soul.  
Your ways, O Lord, make known to me; teach me your paths, Guide me in your truth and teach me, for you are God my savior, and for you I wait all the day.  
To you, O Lord, I lift up my soul.  
Remember that your compassion, O Lord, and your kindness are from of old.  
The sins of my youth and my frailties remember not; in your kindness remember me, because of your goodness, O Lord.  
To you, O Lord, I lift up my soul.  
Good and upright is the Lord; thus he shows sinners the way.  
He guides the humble to justice, he teaches the humble his way.  
To you, O Lord, I lift up my soul.  
All the paths of the Lord are kindness and constancy toward those who keep his covenant and his decrees.  
For your name's sake, O Lord, you will pardon my guilt, great as it is.  
To you, O Lord, I lift up my soul.  
Together pray the Lord's Prayer . . .  
All-powerful God, whose mercy is never withheld from those who call upon you in hope, look kindly on your servant (Name) who departed this life confessing your name, and number (Name) among your saints for ever more.  
We ask this through Christ our Lord.  
Amen.

## MONUMENT & INSCRIPTION RULES AND REGULATIONS

## **Catholic Cemeteries : Diocese of Rockville Centre**

### **Conclusion**

May the love of God and the peace of the Lord Jesus Christ  
bless and console us  
and gently wipe every tear from our eyes:  
in the name of the Father,  
and of the Son, and of the Holy Spirit.  
Amen